

Contents

Product Overview	2
Display Introduction	2
Accessories	2
Connection	4
Driver Installation	6
Windows	6
Mac	9
Driver	12
Driver Interface Preview	12
Pen Display Setting	14
Digital Pen Setting	20
Driver Setting	26
How to Use the Digital Pen	31
Troubleshooting Solutions	32

Product Overview

Display Introduction

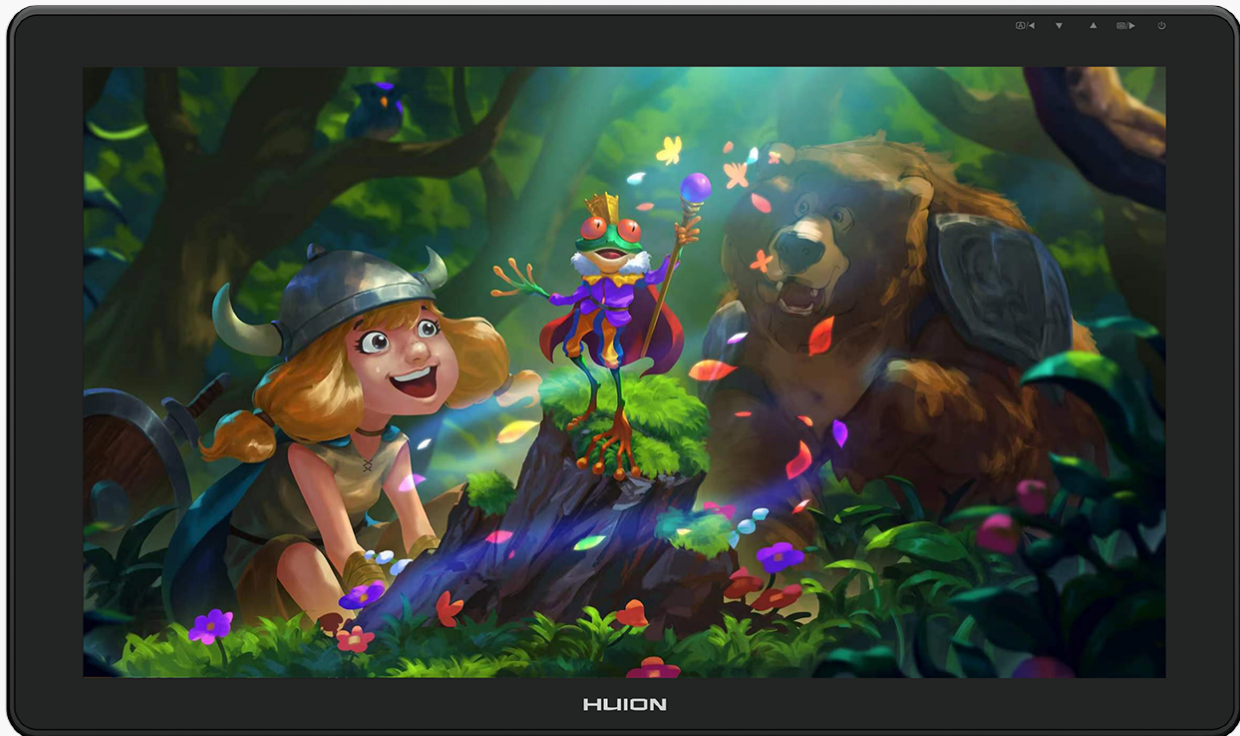

Thanks for choosing HUION Kamvas RDS-220 pen display. As a new generation of professional pen displays, Kamvas RDS-220 features 2.5K resolution and quantum dot technology, which offers you true-to-life details and a cinematic visual experience and enables you to enjoy drawing and creating with higher efficiency. With this pen display, you can freely write and draw, making lines varied in width, painting pictures in different shades of colors, and gaining a pen-on-paper experience.

To better know and use this product, please read this user manual carefully. It shows how to use Kamvas RDS-220 when you connect it to a computer running Windows operating system. It is also applicable to computers running Mac operating system unless a special note is given out.



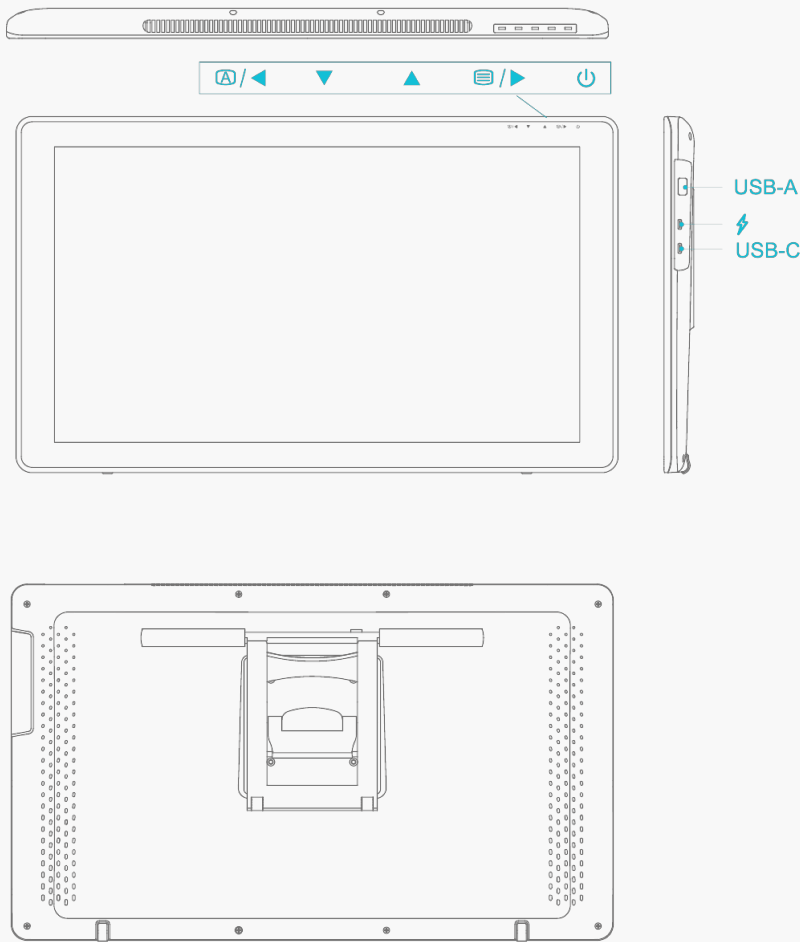

Note: Design and specifications are subject to change without notice. The pictures in the User Manual are for reference only.

Accessories

Product Overview



*Press the button to call up the OSD Menu and change the settings of the menu via 4 buttons (listed on the table below).

Buttons	Functions
	Power on/off the display.
	Press to call up the OSD menu. After entering the menu, its function is "confirm".
	After entering the menu, its function is "to up/right/increase".
	After entering the menu, its function is "to down/left/decrease".
	Before entering the menu, its function is "auto adjustment". After entering the menu, its function is "to the previous menu".

Accessories

- Pen Display*1
- Battery-free Digital Pen*1
- Pen Holder*1
- Standard Pen Nib*5
- Felt Pen Nib*5
- Adjustable Stand *1
- 3-in-2 Cable*1
- Full-featured USB-C To USB-C Cable*1

Power Adapter*1
Quick Start Guide*1
Cleaning Cloth*1

Setting Up Display

This ergonomic adjustable stand is specially designed for your Kamvas display and you can adjust the display to find a comfortable angle according to your usage habit when painting and creating , the stand angle between 20° and 80°.

Take out the pen display and stand from the package, then assemble the stand to the back of the display with the attached screwdriver according to the following instructions.

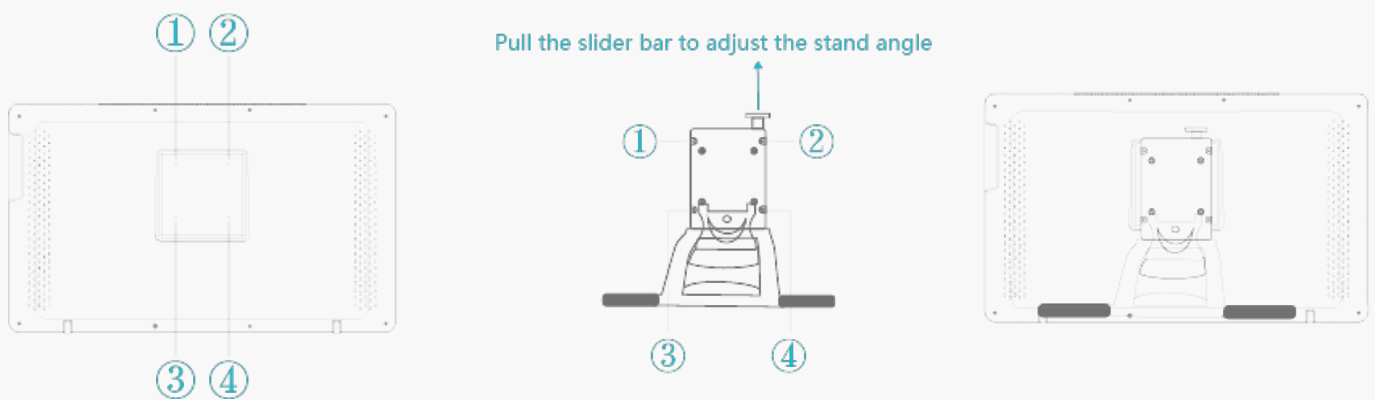

Connection

Kamvas RDS-220 supports both computers and Android devices. The following are ways of connection for reference.

Connect via a Three-in-two Cable

- 1.Take out the 3-in-2 cable from the package.
- 2.Connect the pen display to your computer via the 3-in-2 cable (See the picture below).
- 3.Plug the power cable into a power adapter and connect the power adapter to the power source.
- 4.Now you can use your pen display.

*If the included power cable is too short to connect the display to the power supply, please purchase an extra extension cable. Any USB power adapter is usable as long as the output is 12V, 3A.

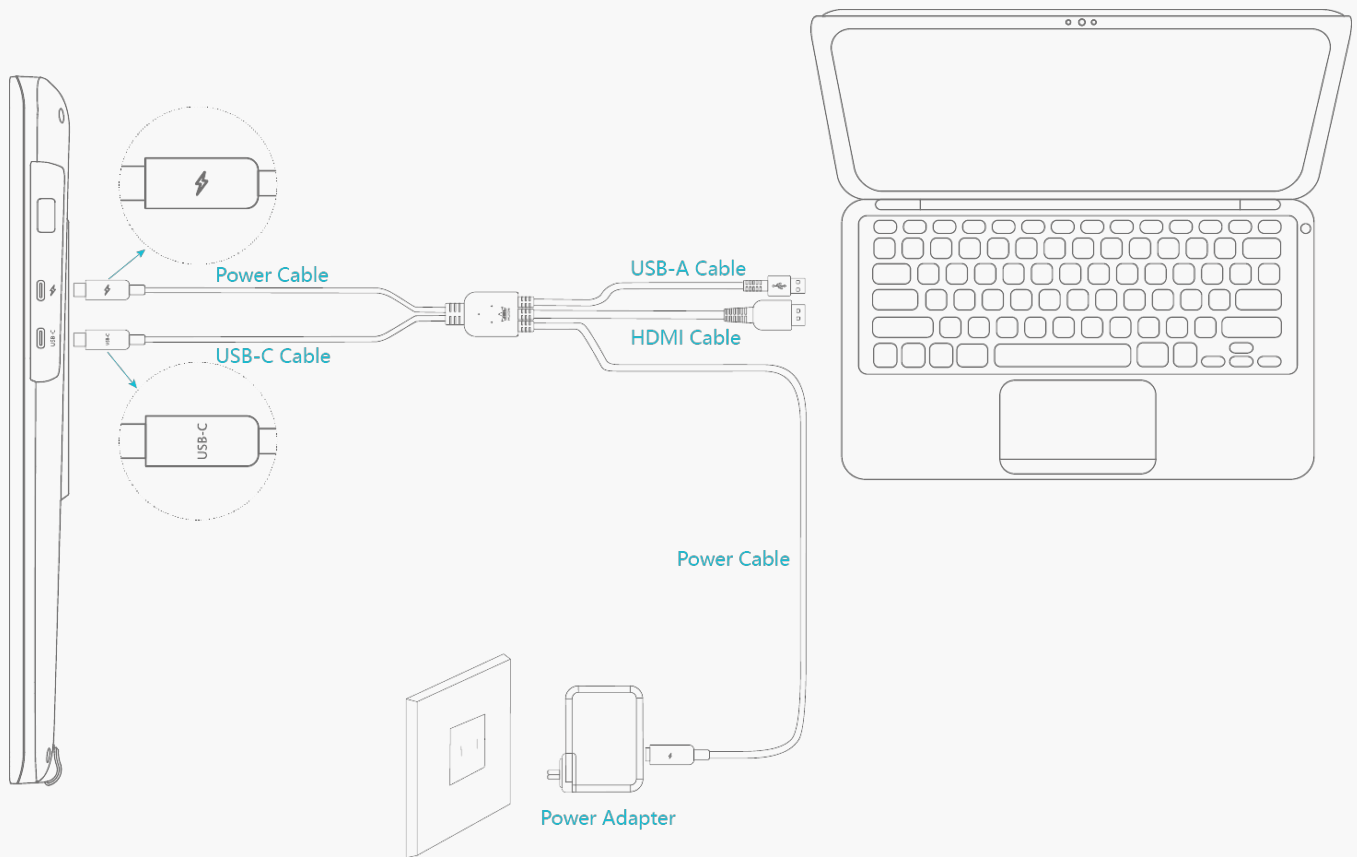

Connect via a Full-featured USB-C to USB-C Cable

1. Take out the full-featured USB-C to USB-C cable and 3-in-2 cable from the package.
2. Connect the pen display to a power adapter via the 3-in-2 cable (the port ① and the two power cable ends are used).
3. Connect the pen display to your computer or Android device via the full-featured USB-C to USB-C cable (the port ② is used).
4. Now you can use your pen display.

*Users can buy a full-featured USB-C to USB-C cable or a power cable separately, but make sure the former supports at least USB3.1 GEN1 data transfer protocol & DP1.2 and the output is at least 12V, 3A.

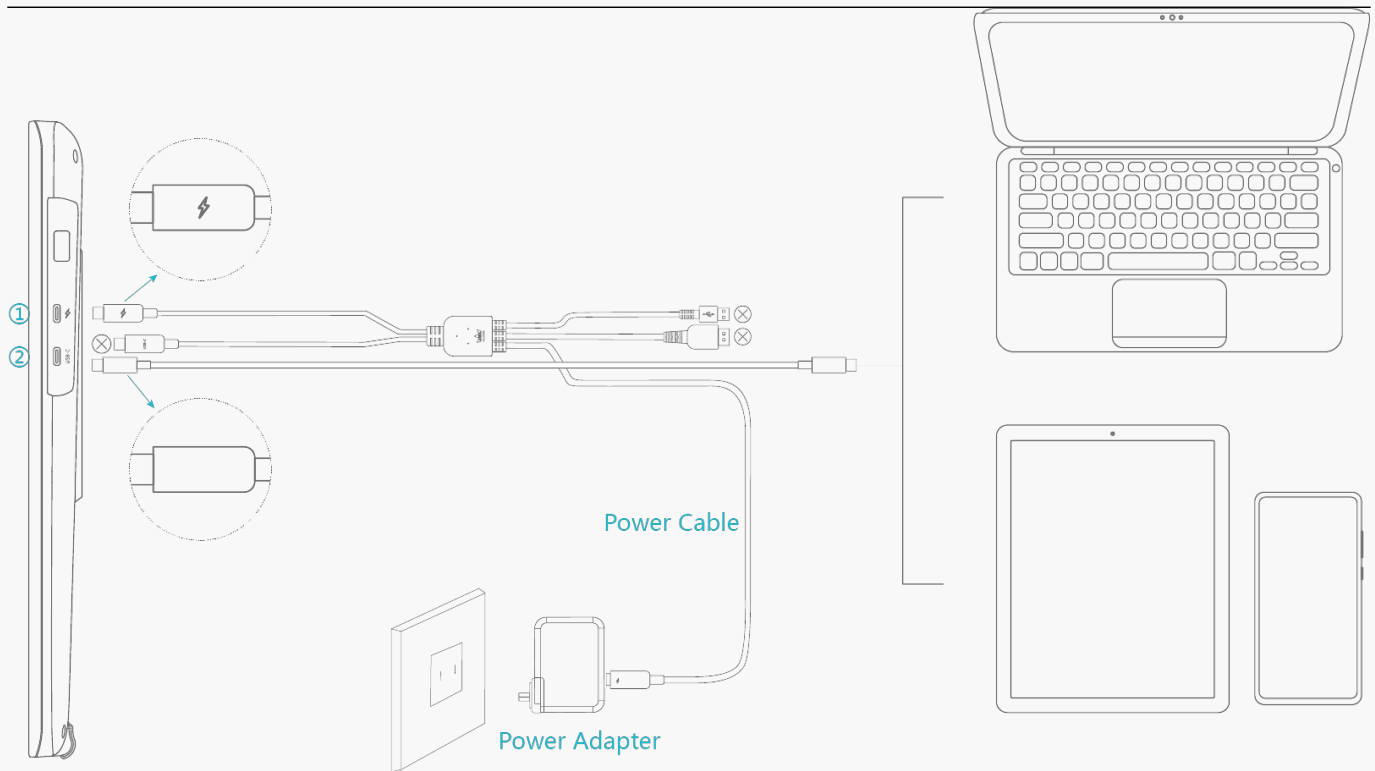

Driver Installation

Windows

How to Install the Driver on Windows Device

Notice:

- ① Before installing the driver, please close all graphic software and antivirus programs. The note ("HuionTabletCore.exe" failed to launch!) below appears only on devices with Windows OS, indicating that the driver is blocked by antivirus programs or drawing applications.
- ② Please make sure your computer operating system is Windows 7 or later.
- ③ Open the driver and a picture of Kamvas RDS-220 will appear, indicating that the pen display is successfully connected to your computer. Now you can use your pen display.
- ④ If the connection fails, please restart the driver or your computer.

Note: The pen display cannot work once the driver is uninstalled or deleted. In this case please click [Driver-Kamvas RDS-220](#) to reinstall a driver, and your pen display and digital pen will restore to their default settings.

Driver Installation

1. Connect the pen display to your computer.
2. Choose the correct driver for your device from our website: [Driver-Kamvas RDS-220](#).
3. Click Driver-Kamvas RDS-220 to download it.
4. Double-click the driver and click "OK" to proceed.

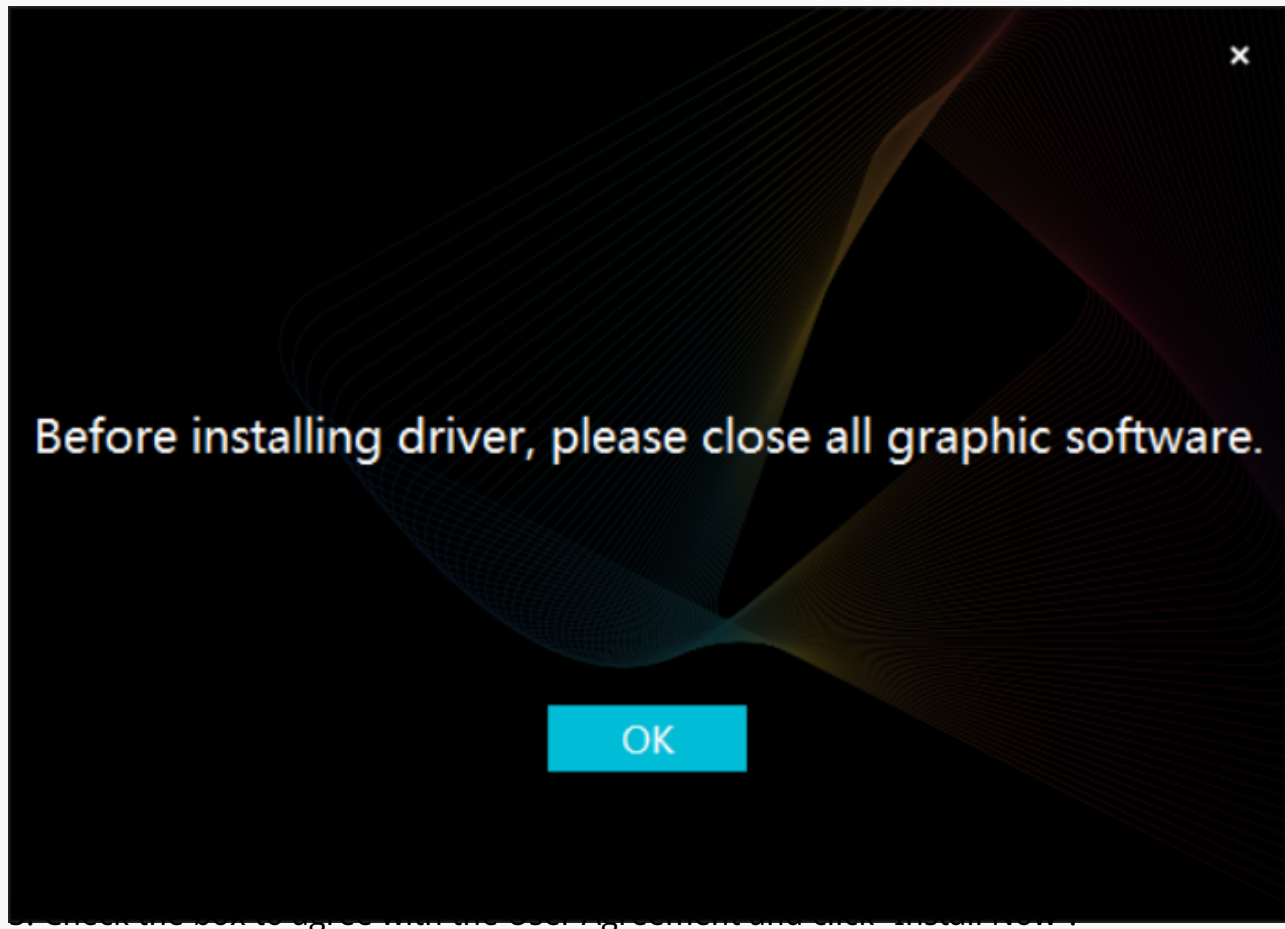

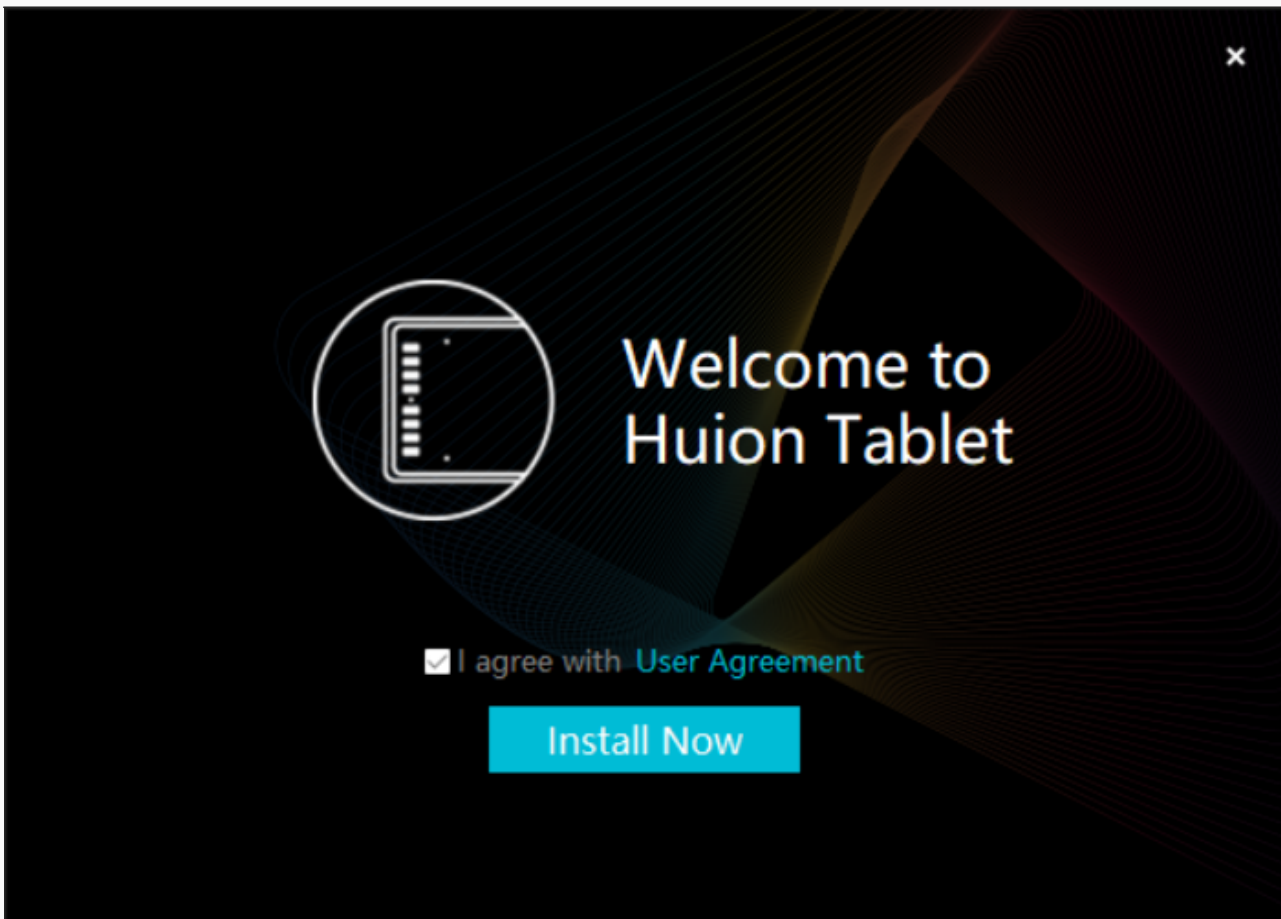

6. After the installation has been completed, click on "Try it now".

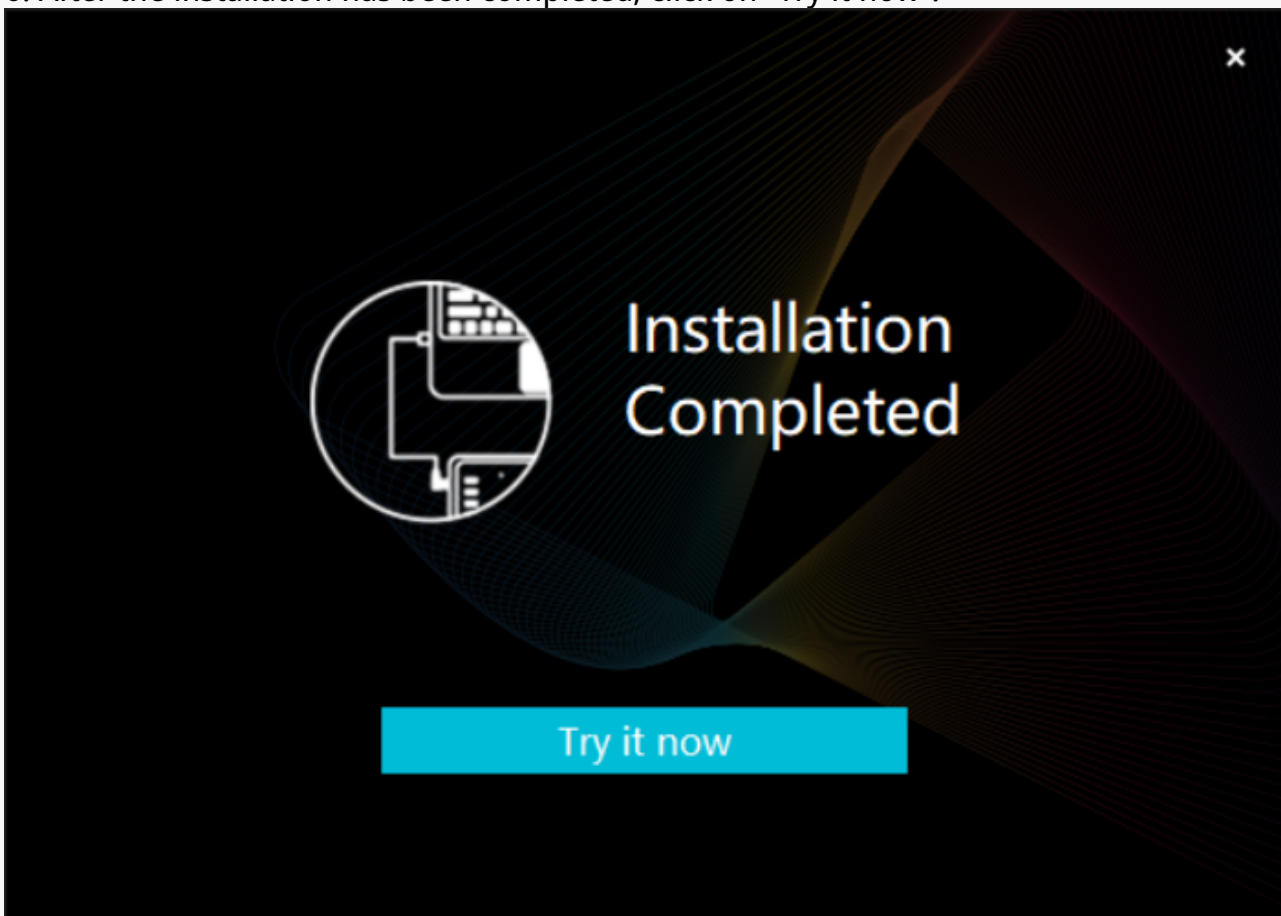

7. A picture of Kamvas RDS-220 will appear on the driver interface to indicate a successful connection. Now you can use your pen display.

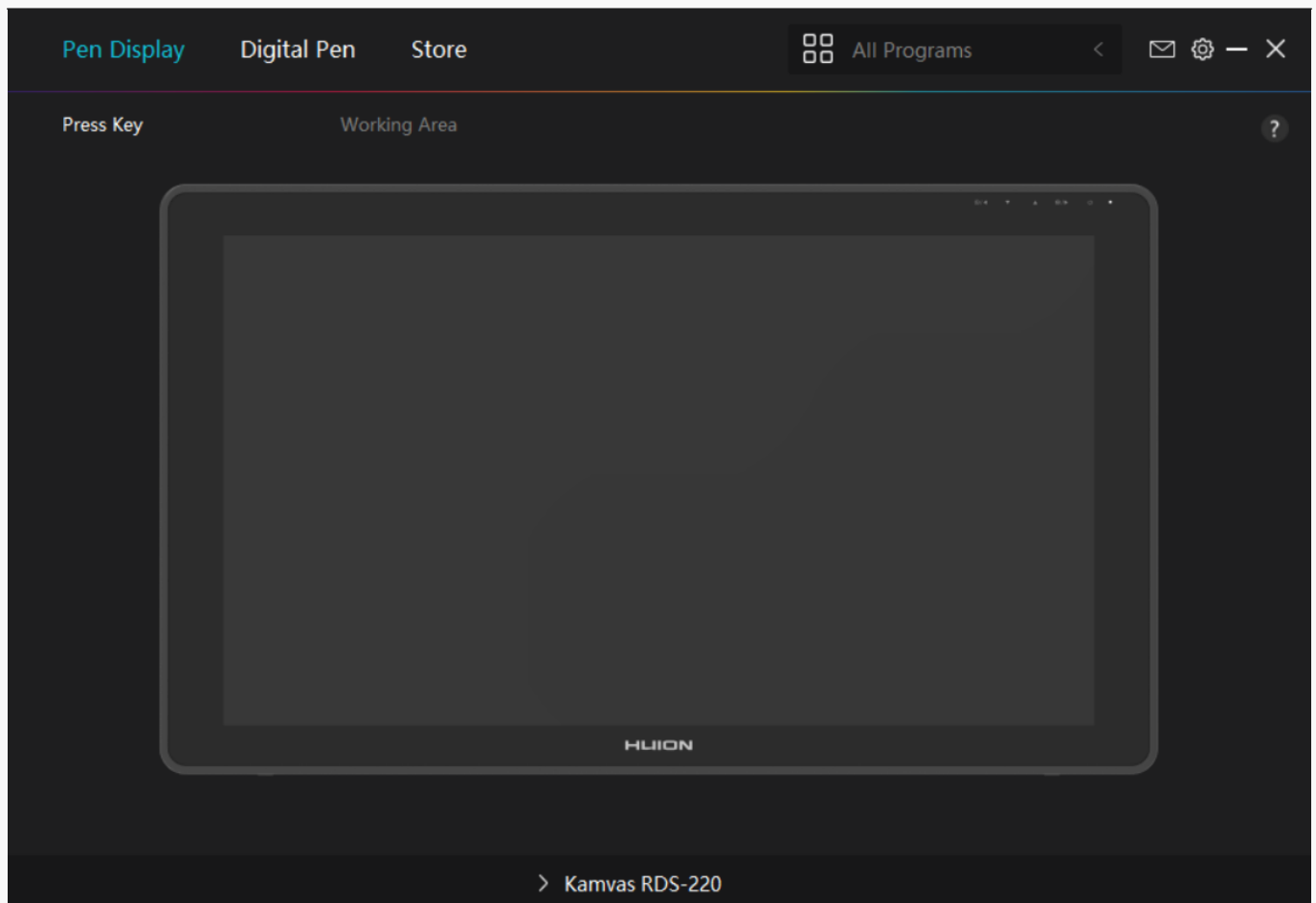

Mac

How to Install the Driver on Mac Device

Notice:

1. Please make sure your computer operating system is macOS 10.12 or later.
2. Open the driver and a picture of Kamvas RDS-220 will appear, indicating that the pen display is successfully connected to your computer. Now you can use your pen display.
3. If the connection fails, please restart the driver or your computer. For more information, please refer to Troubleshooting. See section.

Note: The pen display cannot work once the driver is uninstalled or deleted. In this case please click [Driver-Kamvas RDS-220](#) to reinstall a driver, and your pen display and digital pen will restore to their default settings.

Driver Installation

1. Connect the pen display to your computer.

2. Choose the correct driver for your device from our website: [Driver-Kamvas RDS-220](#).
3. Click Driver-Kamvas RDS-220 to download it.
4. Unzip the driver file and drag the HuionTablet driver application into the "Applications" folder.



5. Open the folder and then find and double-click the HuionTablet driver application.

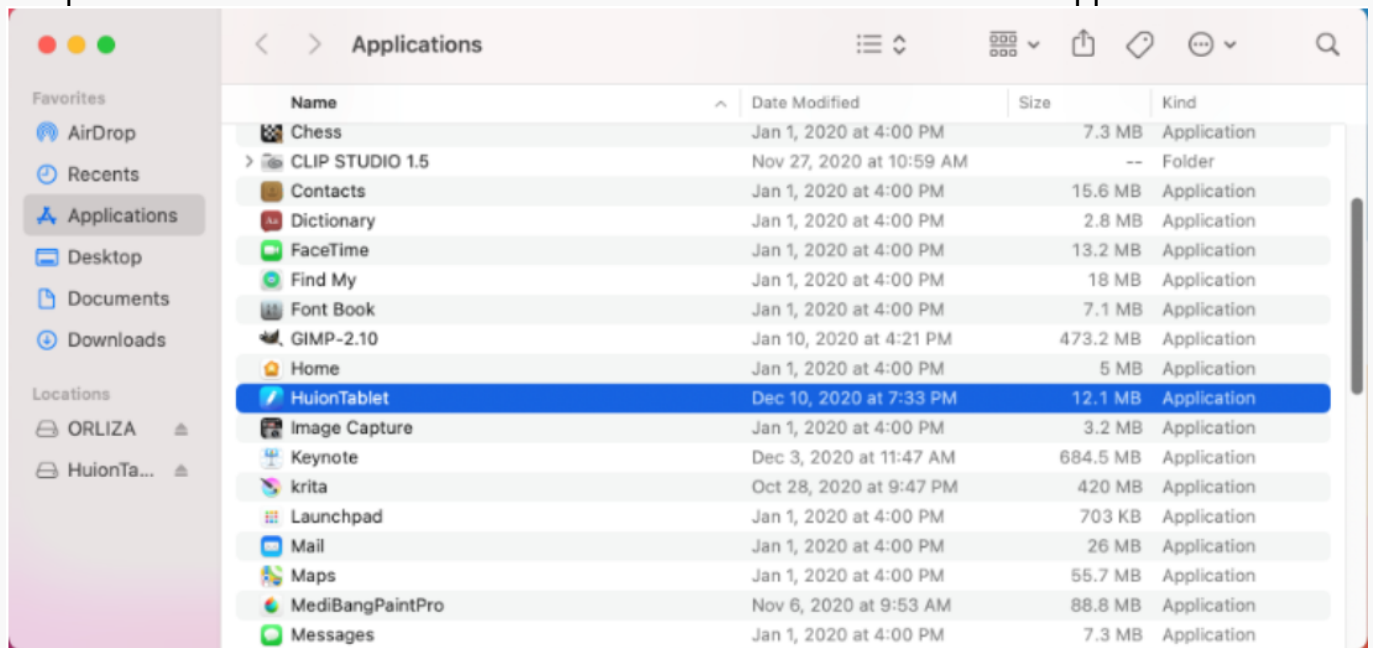

6. Connect the pen display to your Mac, and click "Open System Preferences" when prompted. Go to Security & Privacy > Privacy > Accessibility settings and click the lock icon to unlock the settings. Tick the checkbox on the left of the HuionTablet driver application to enable accessibility. Then click the lock icon to lock the settings.

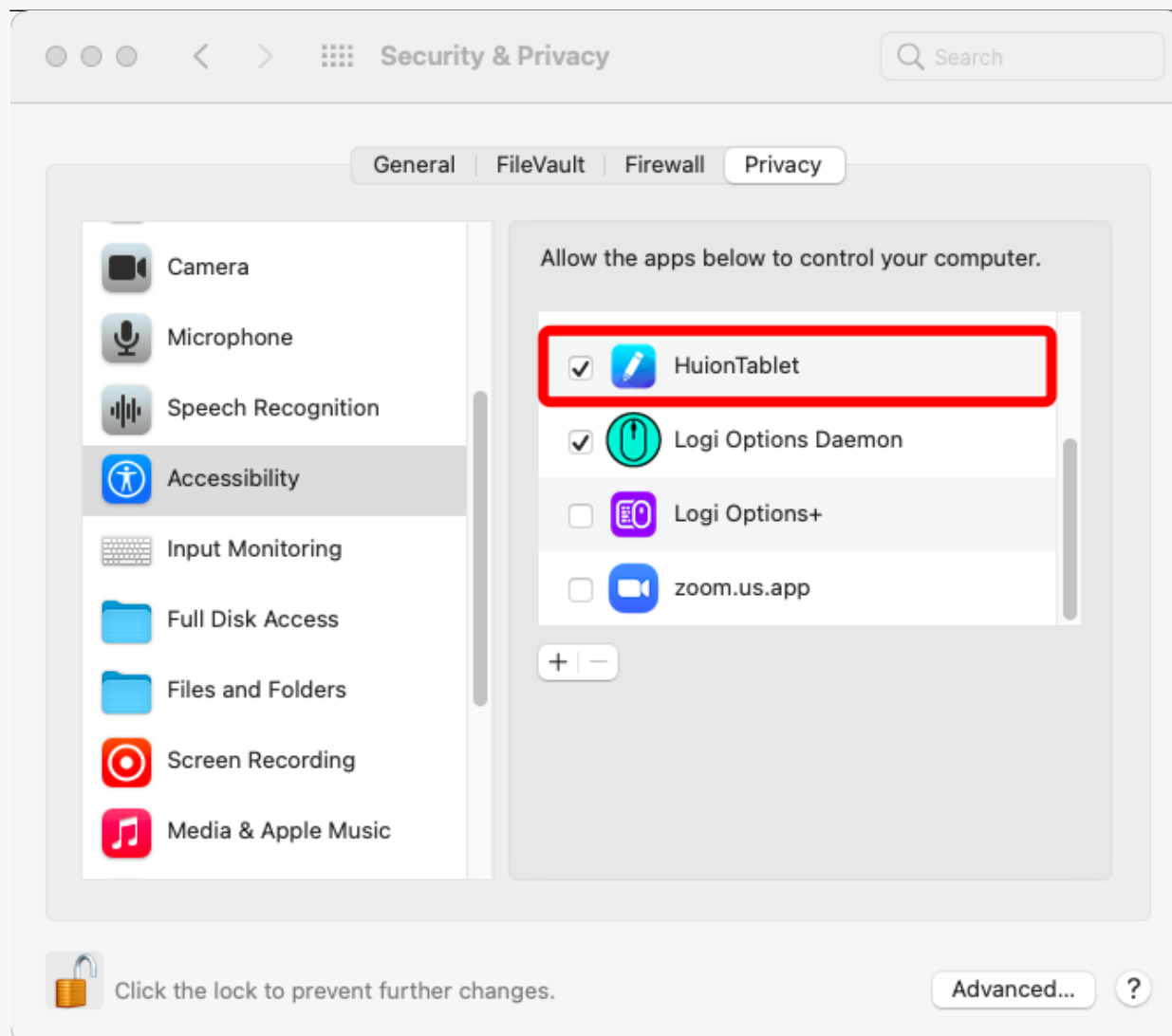

7. Just click "OK" when the system prompts for a Bluetooth connection, even if the pen display is connected to your computer via a cable.

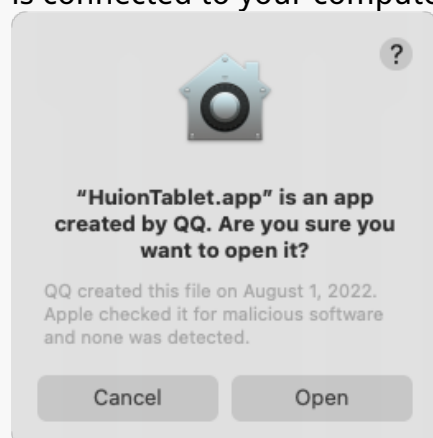

8. A picture of Kamvas RDS-220 will appear on the driver interface to indicate that the pen display is successfully connected to your computer. Now you can use your pen display.

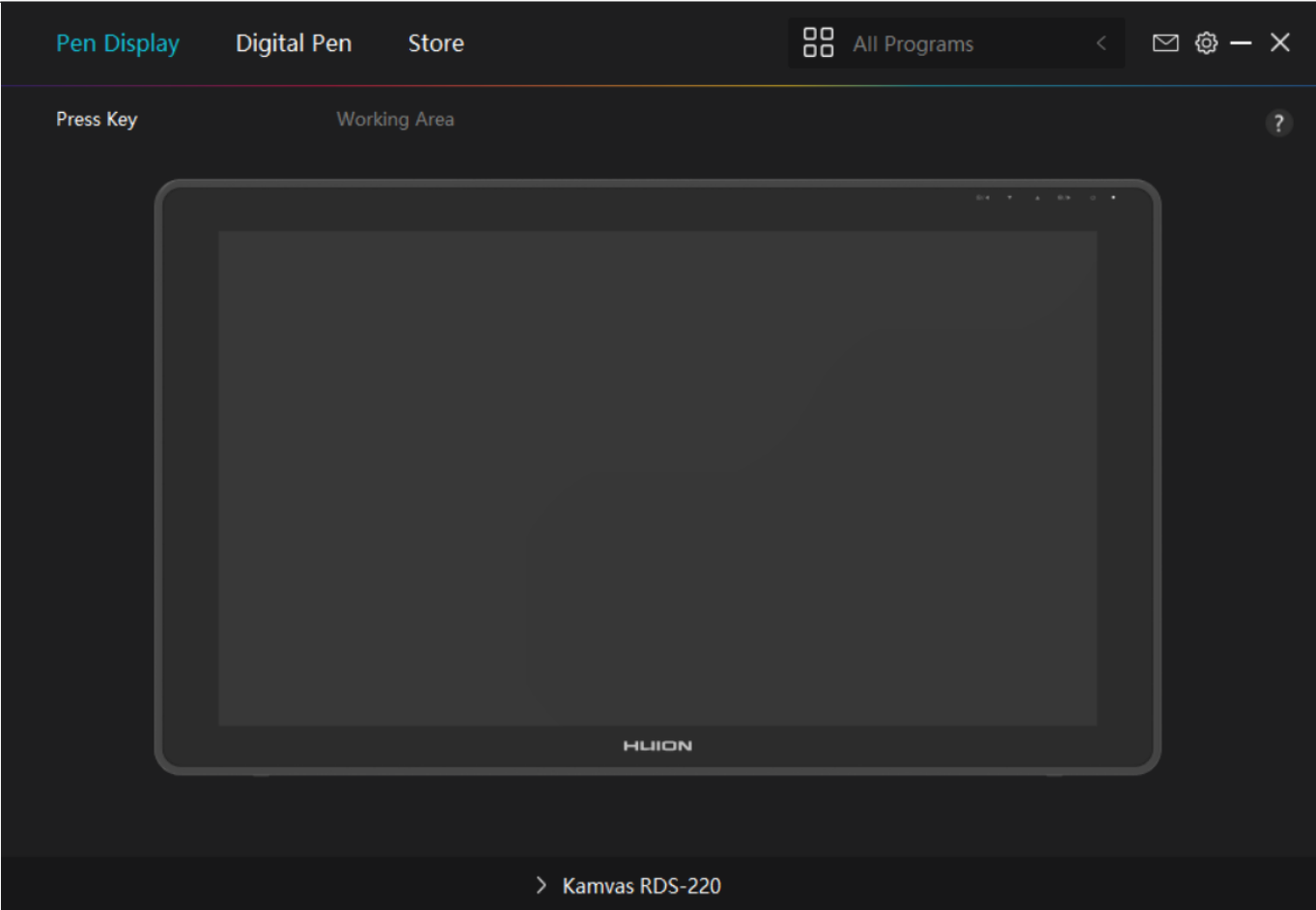

Driver
Driver Interface Preview

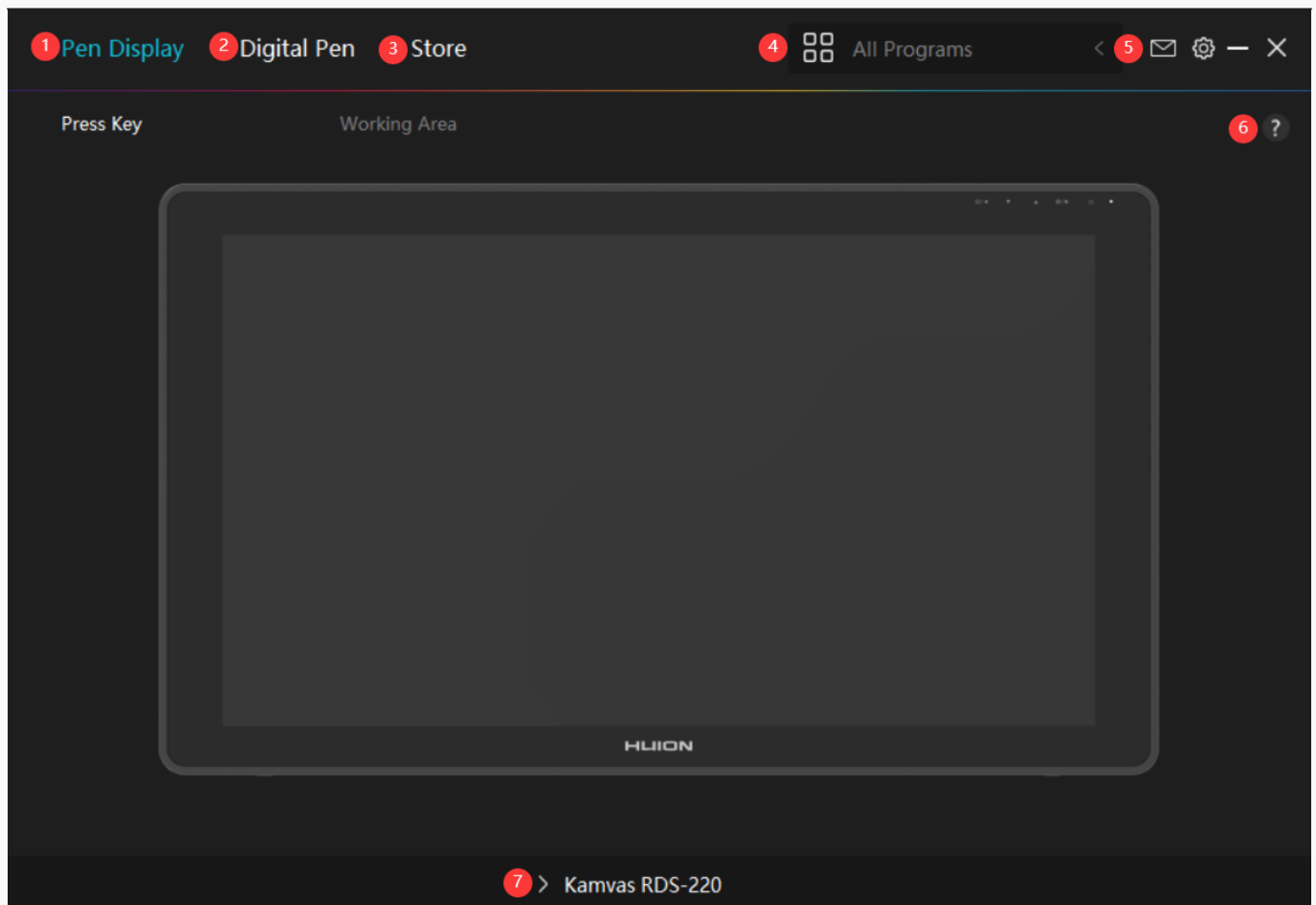

1. Pen Display

On the “Pen Display” interface, users can set functions of the display, including Press Key and Working Area Set.

[See Section](#)

2. Digital Pen

Users can set functions of the pen on this “Digital Pen” interface, including Press Key, Mode selection, Pressure Sensitivity Adjustment, and Pressure Test.

[See Section](#)

3. Store

Huion Store is where you can get the latest information about the product such as its FAQ or sales promotion. In addition, you can also purchase Huion’s other products or accessories here.

4. Add Programs

1. Some programs which have already been opened will appear for you to choose from after clicking Add a Program on the screen. For more programs, click Browser and choose the item that you want to get it added.
2. You can set different functions for different programs. Functions of the press keys change automatically as you switch from one program to another.
3. When you select "All programs", the functions of press keys that you set are valid for every program. By clicking Add a Program from the drop-down list, you can set the functions for a specific program and hence have unique settings for different programs. After that, when you launch a specific program, the Driver will automatically recognize it and the setting features will change to its corresponding ones.

5. Setting

Users can set the functions of a driver on this interface, including check out Device information, Backup setting, General setting, and its version.

[See Section](#)

6. Common Problems

Click "?" and jump to Forum in our website <https://support.huion.com/en/support/home> to get a user manual or feed back the problems to us.

7. Switch between Devices

The Driver is able to support two devices at most. Functions of them can be customized by users respectively. When switch to one of them, functions change to its corresponding ones.

Pen Display Setting

Working Area

Select the Working Area tab to adjust the ratio of the distance of pen movement on the pen display to that of the corresponding cursor movement on the monitor. By default, the entire active area of the pen display maps to the whole monitor.

If more than one monitor is in use and they are in extended mode, users need to choose one that will be mapped to on the driver interface and the other one as the external display.

In mirror mode (All monitors display the same content), the pen display maps to the entire screen on each monitor and cursors displayed on them move simultaneously.

1. Working Area Setting

Define the pen display area that will be mapped to the monitor. Three modes on the driver can be chosen:

[1] Full Area: The entire active area of the pen display will be mapped to the monitor. It is the default setting.

[2] Screen Ratio: The ratio of the active pen display area depends on that of the display device. In Screen Ratio mode, these two ratios keep the same. For example, if you choose the screen ratio and draw a circle on the pen display, then a circle appears on the monitor that has been connected to the pen display, in this case some parts of the pen display may not work. But if you don't choose the screen ratio and draw a circle, then the circle may change into an oval on the monitor.

[3] Custom Area:

1> Enter coordinate values.

2> Users can adjust the working area of the pen display by changing the outlines of the smaller rectangle (see picture 1). Users can also drag the two blue rectangles to select the active areas of the digital pen on the screen and the pen tablet. (see picture 2 and 3).

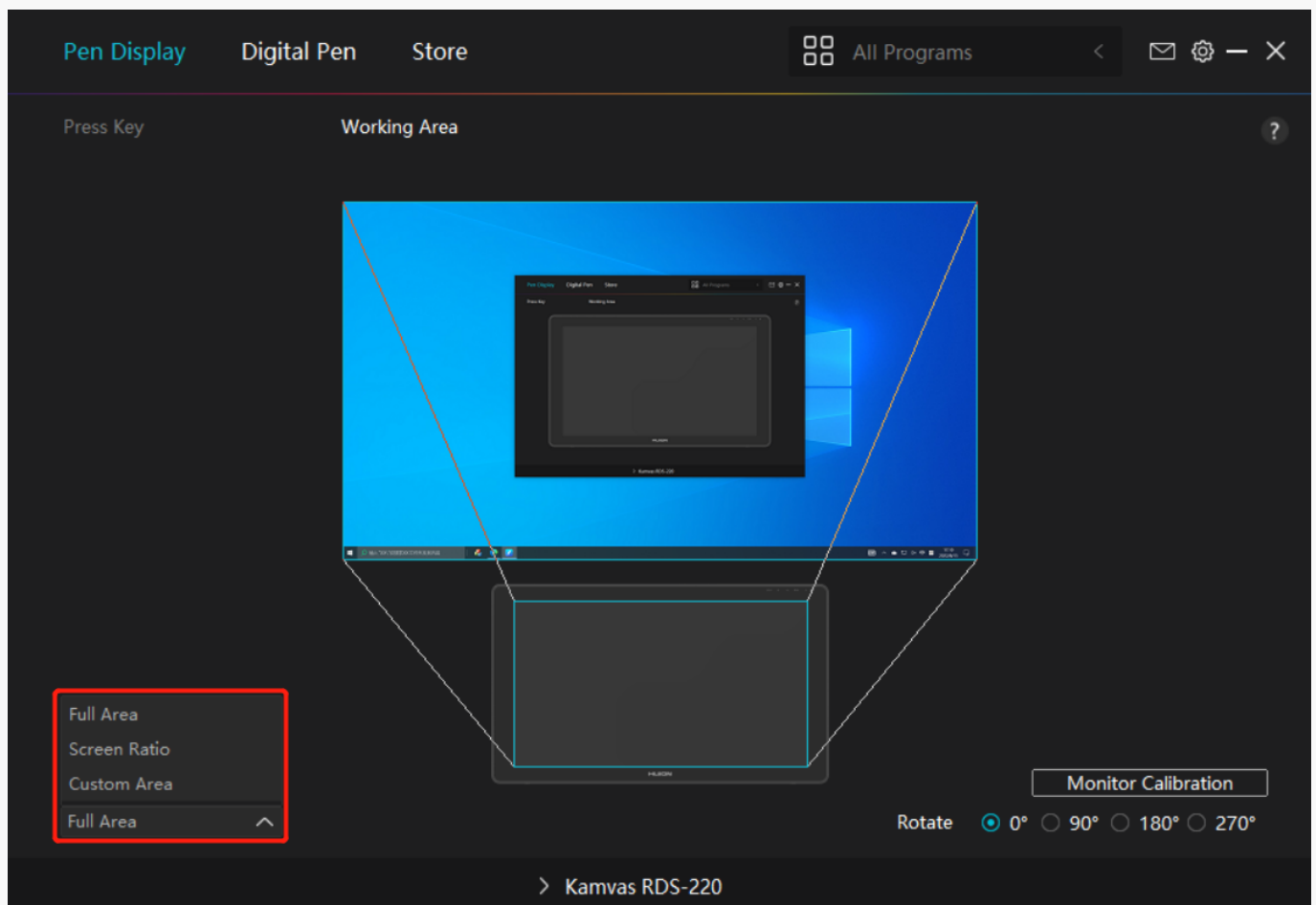

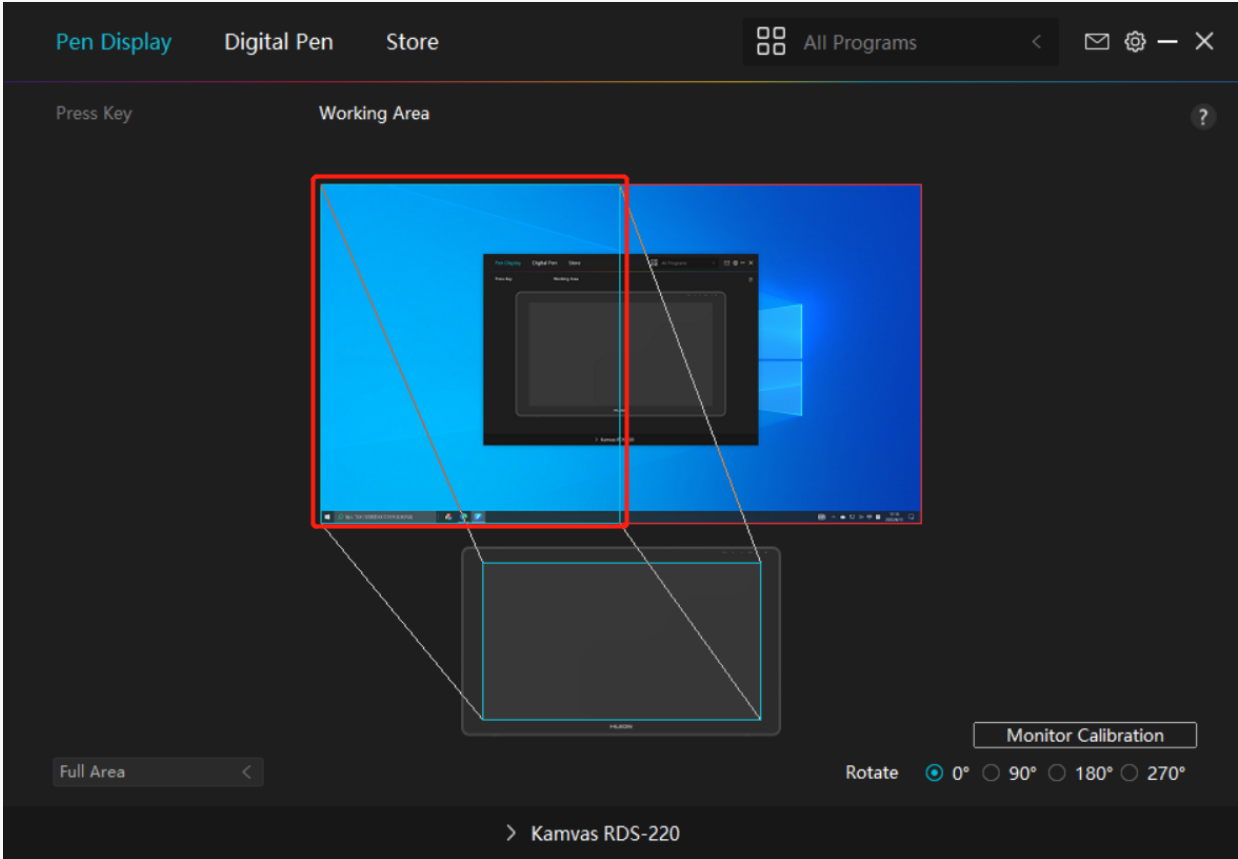

Picture 1

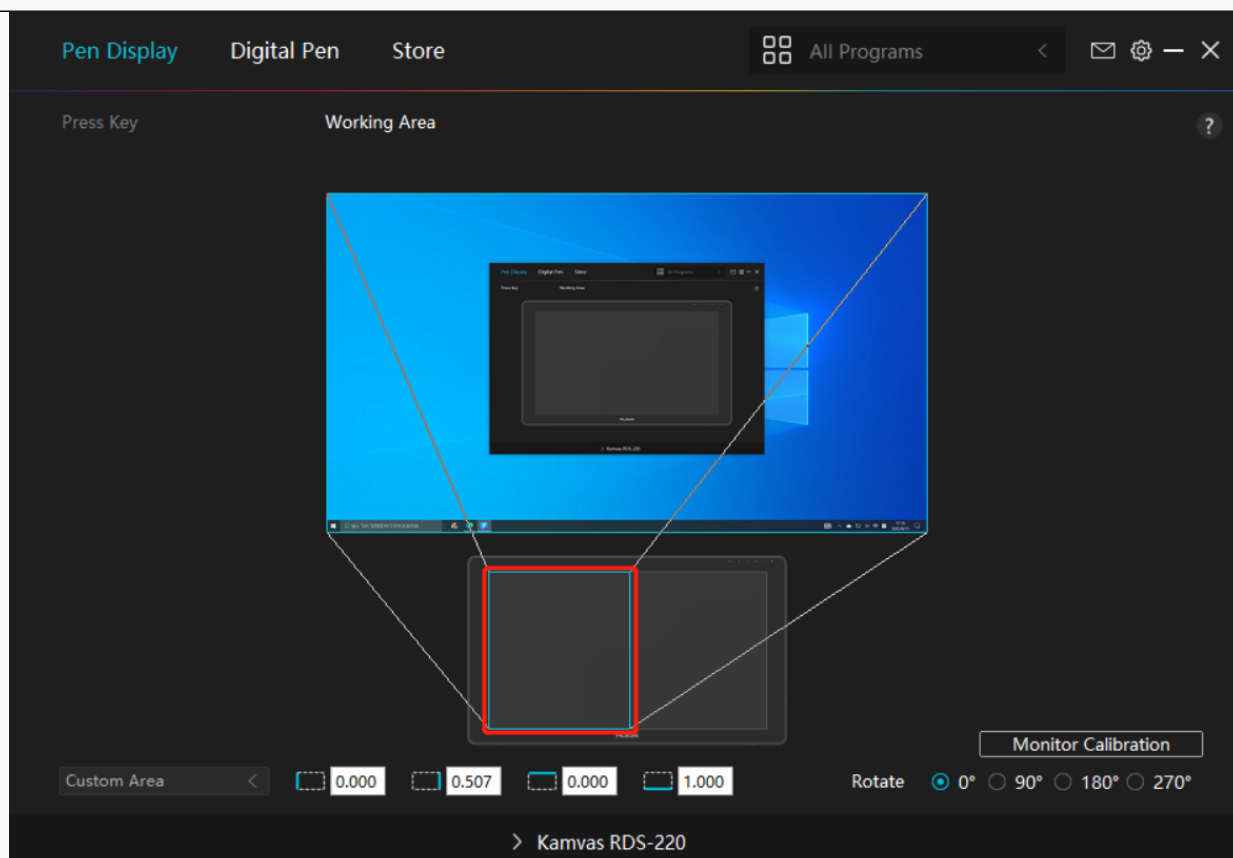

Picture 3

2. Rotate Working Area

Both left-handed and right-handed users can freely use the pen display because it can be rotated by 0°, 90°, 180° or 270°.

Picture 2

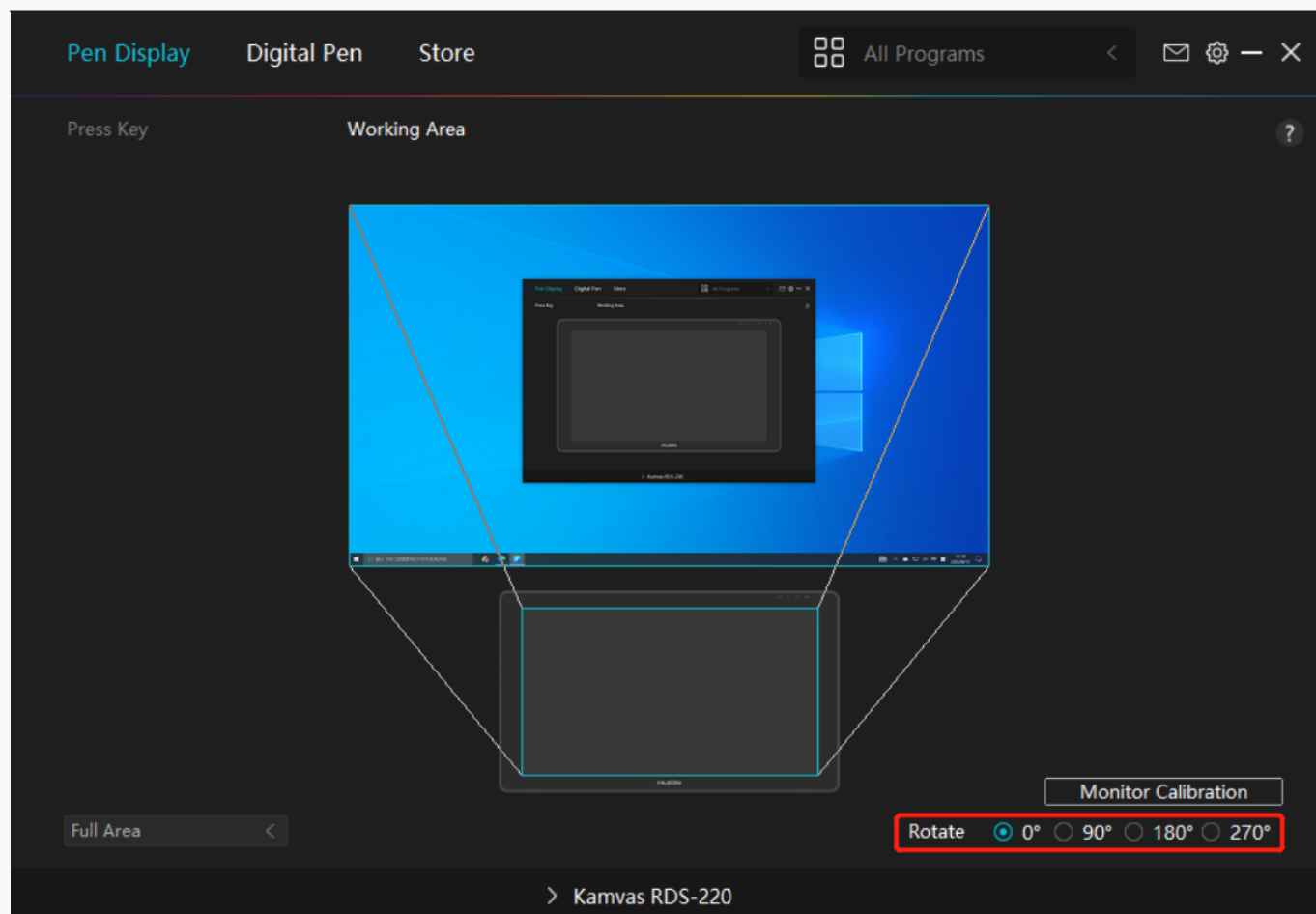

3. Calibrate Your Pen Display

Click Monitor Calibration tab and follow the instructions to calibrate your pen display.

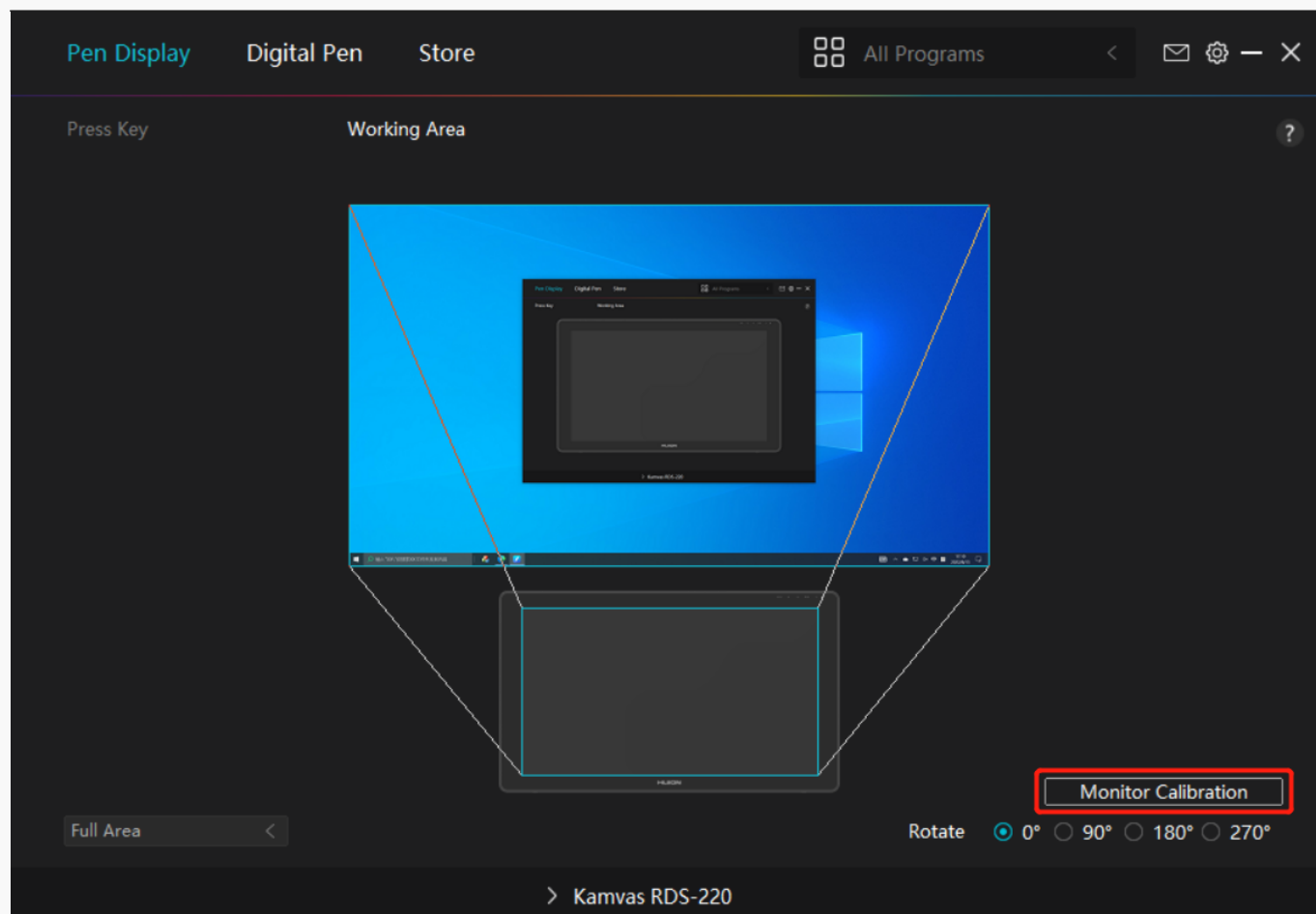

Please use the digital pen to click on the center red dot of the cross in a common pen-holding posture. You can cancel Calibration and restore default.

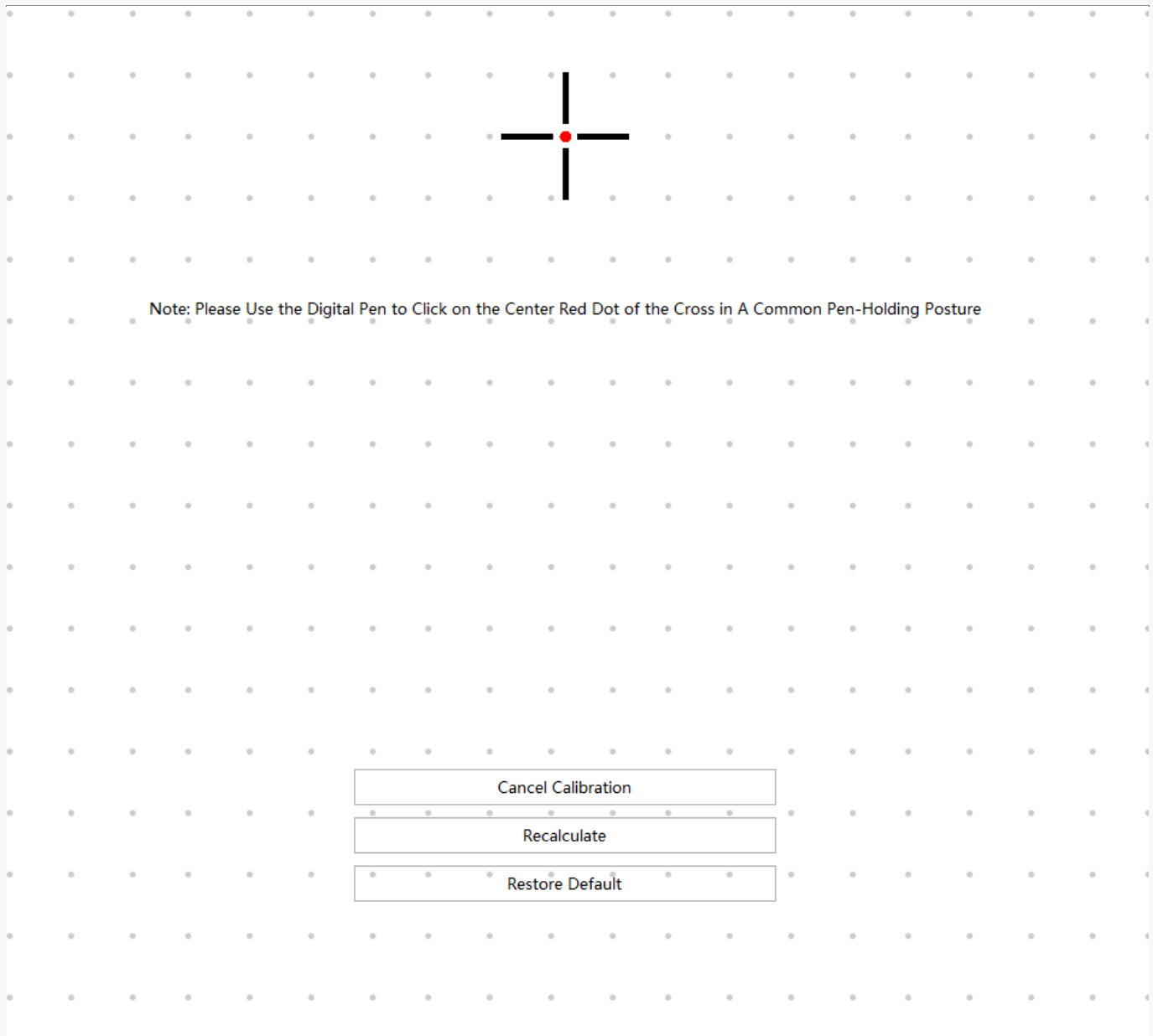

Digital Pen Setting

1. Press Key

You can use this digital pen to interact with your device, including drawing, writing, moving files, or activating the functions of pen press keys.

You can customize the functions of these press keys according to your own habits, and you can uncheck "Enable press keys" in the lower left corner to turn off these functions. Place the cursor over one of the buttons on the screen of your computer to check its default value. Click a button and then a pop-up dialog box appears. Choose what you want and set its function.

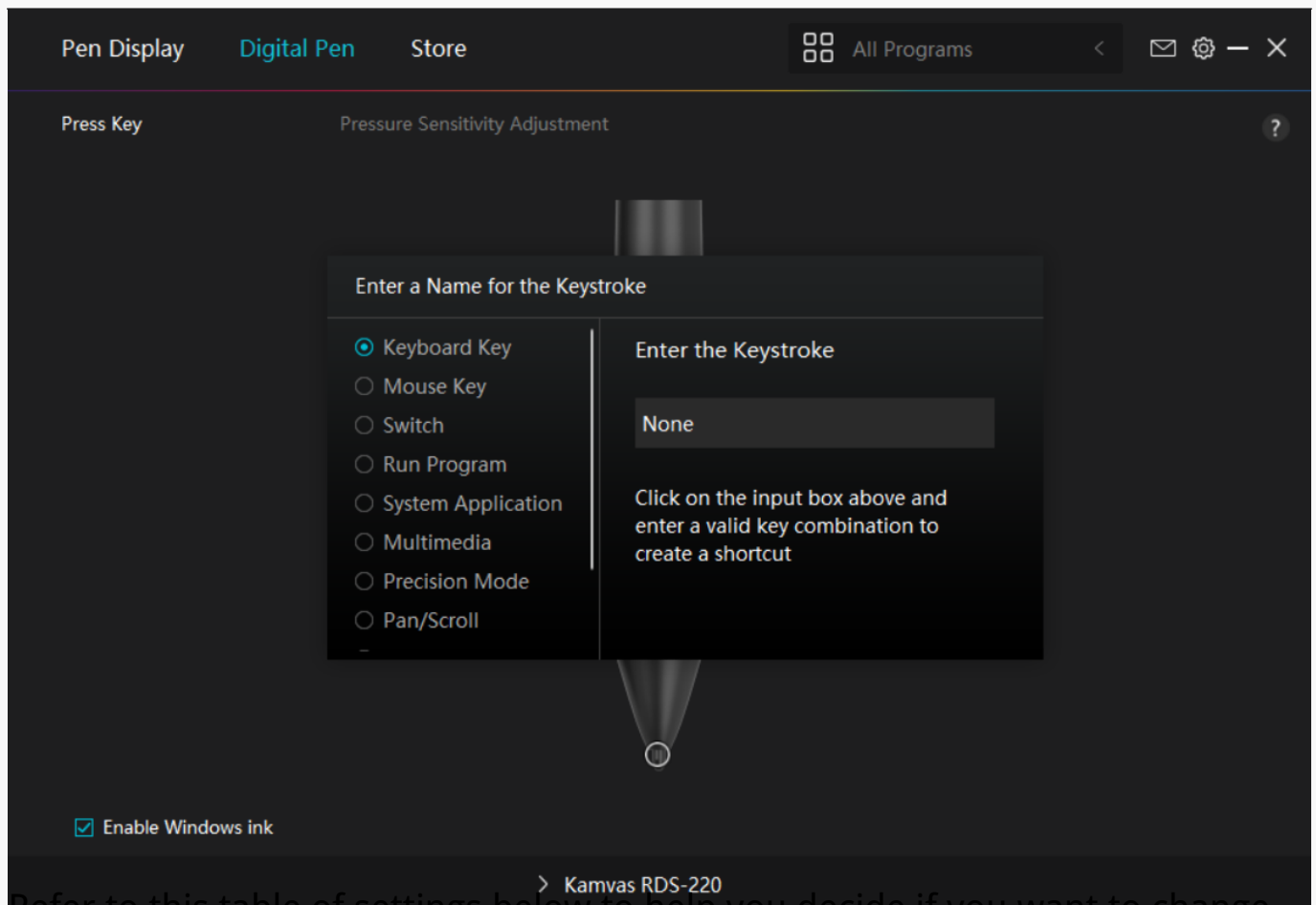

Refer to this table of settings below to help you decide if you want to change the existing settings.

Note: The performance of functions in the table below is up to the device that users have connected.

Keyboard Key	Click on the input box above and enter a valid key combination to create a shortcut.
Mouse Key	Select the functions of a Mouse or Wheel. Please see the picture below for detailed information of these functions. Mouse: Left Button, Right Button, Middle Button, and Double-left Click. Wheel: Wheel Forward and Wheel Backward. Other functions: Ctrl, Alt, Shift, and Win .
Switch	Select among Switch Screen, Switch Brush.
Run Program	Click Browse and select the program that you want to run quickly. After that, press the key to launch the item.
System Application	You can apply these functions to press keys: Lock the Screen, Sleep, Power Off, Show/Hide Desktop, Task View, Start Menu, and Calculator.
Multimedia	You can apply these functions to press keys: Previous Song, Next Song, Play/Pause, Volume up, Volume down, and Muted.
Precision Mode	You can toggle between normal precision and a precision that

you choose, from Fine to Ultra Fine. In the Precision Mode window that appears, move the slider to set the precision that you toggle into. For example, if you assign Precision Mode to a pen button, when you press the pen button, you switch to working in the precision that you selected from the slider. When you press the pen button again, you switch back to working in the normal precision. Press "Esc" to exit Precision Mode.

Pan/Scroll	This function allows you to pan and scroll in a document or item by moving the pen tip up and down or right and left. When you select Pan/Scroll, the Scroll Speed window appears. Move the slider to your preferred scrolling speed.
Quick Menu	Pick it up and you can use the key to pull up the Quick Menu. Detailed information for reference is down below this table.
Fixed Pressure Sensitivity	You can lock the pressure at the current level until you release the component. For example, if you assign this setting to a pen button, you can paint with pressure sensitivity enabled in your application until you reach the brush size you like. Then, press and hold the pen button to lock in that brush size as long as you are pressing and holding the button.
None	When select None, the keys will not work.

Note: The pictures are for reference only.

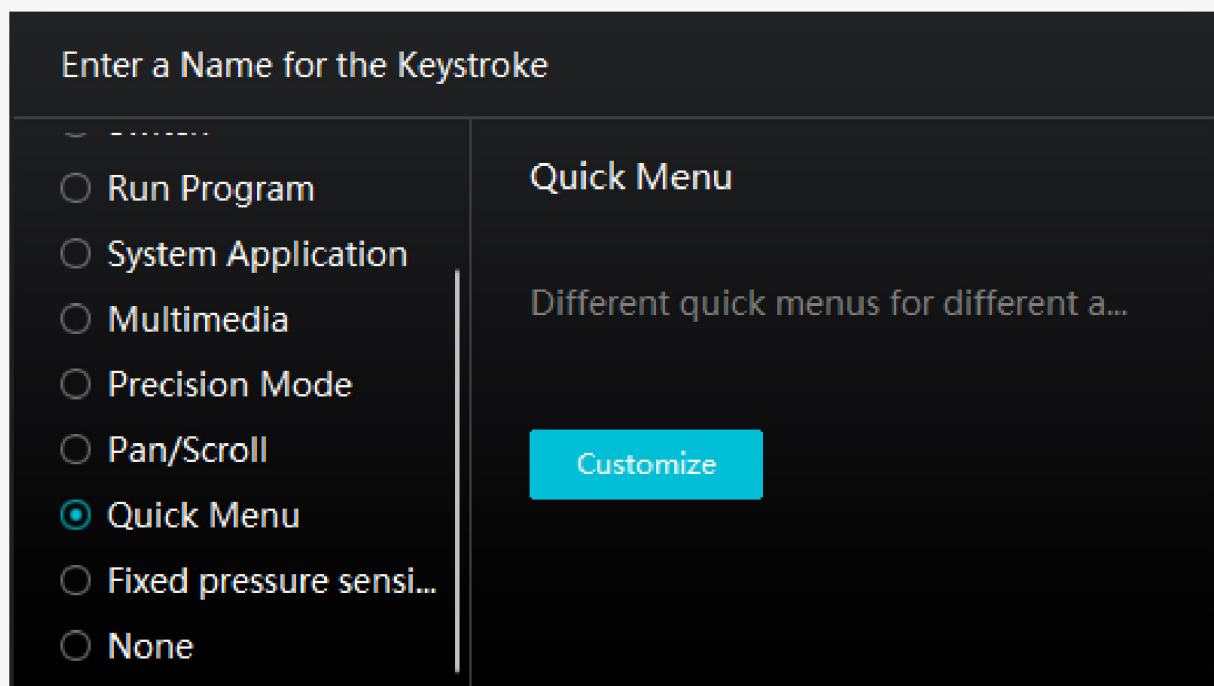

Click Customize in the picture above to call out a quick menu (see picture 1). For each of the six buttons on the left, users can enter a name for it and set unique function for it. After that, users can call up the Quick Menu by pressing the key (see picture 2). The menu disappears after a click on any of the six buttons. By clicking "Fix" once the menu will be fixed on the desktop while after a second try the "Fix" button changes to "Close" and the menu disappears (see picture 3). Put the cursor on the menu to drag it.

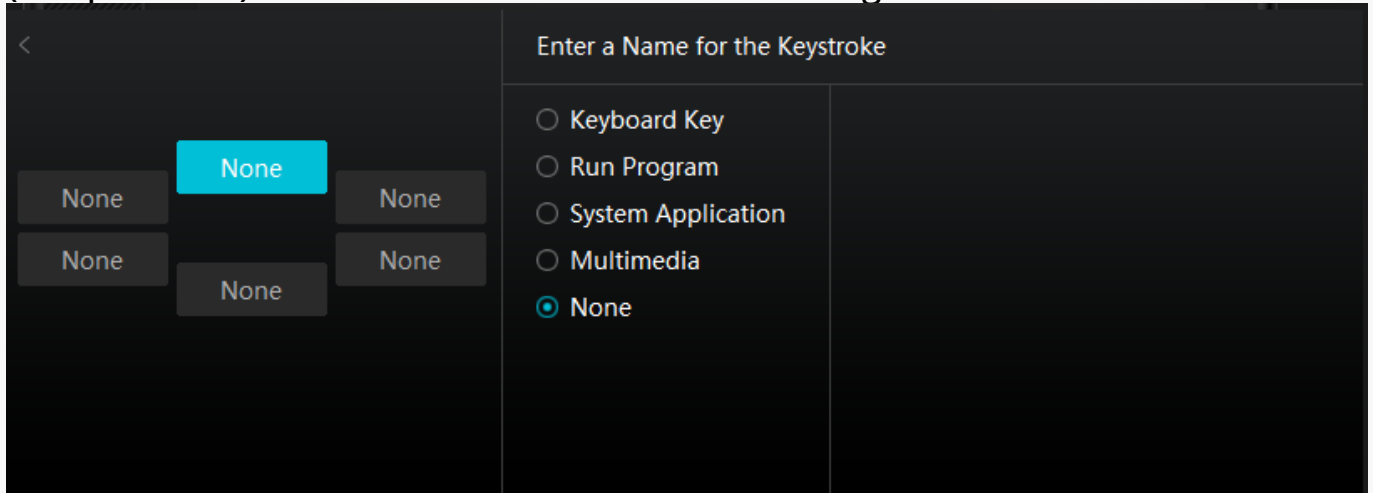

Picture 1

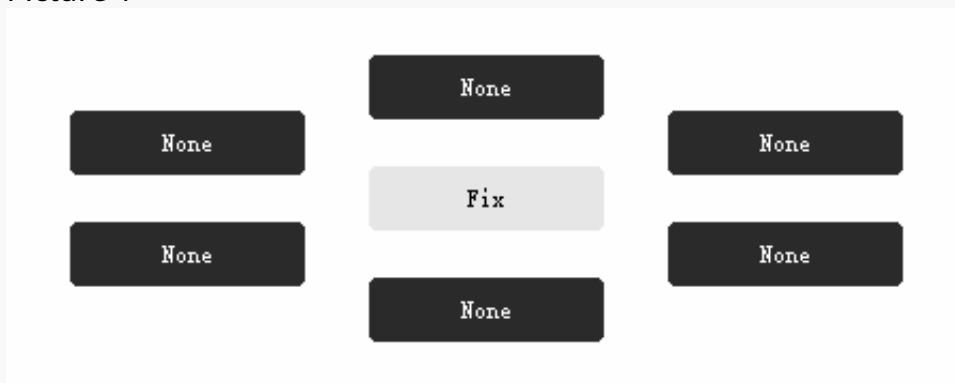

Picture 2

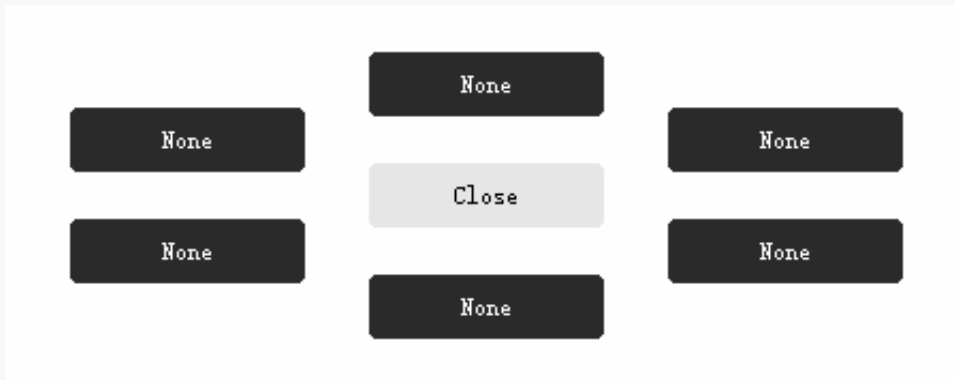

Picture 3

2. Pen Nib Activity

The pen nib of the digital pen can be set as Valid/Invalid according to users' needs. Click the drop-down button to set its activity. In Valid mode, the pen works well, and in Invalid mode, the pen has a cursor movement, but cannot complete specified actions.

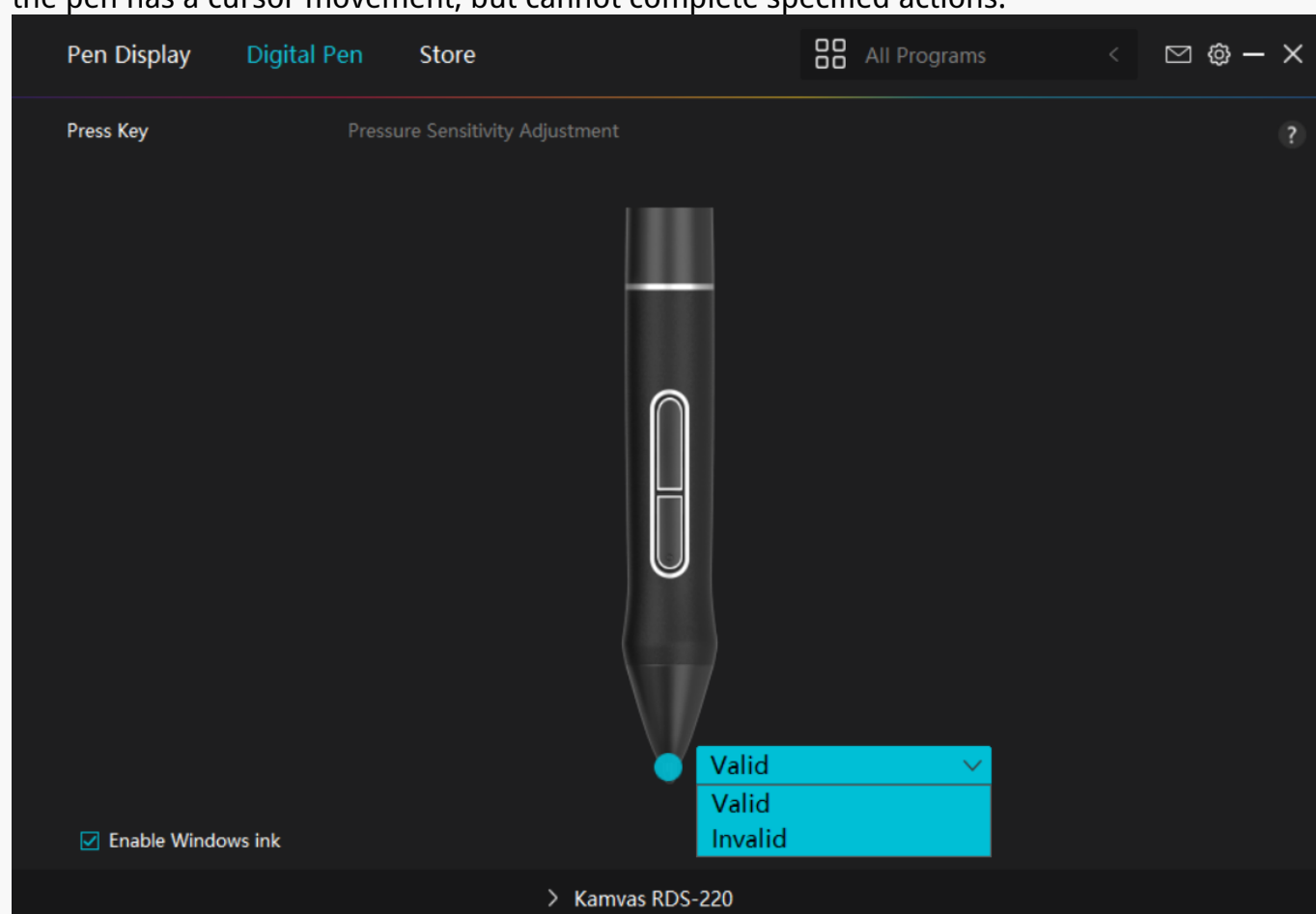

3. Enable Windows ink

Microsoft Windows provides extensive support for pen input. Pen features are supported in such as Microsoft Office, Windows Whiteboard, Adobe Photoshop CC, SketchBook 6 and so on.

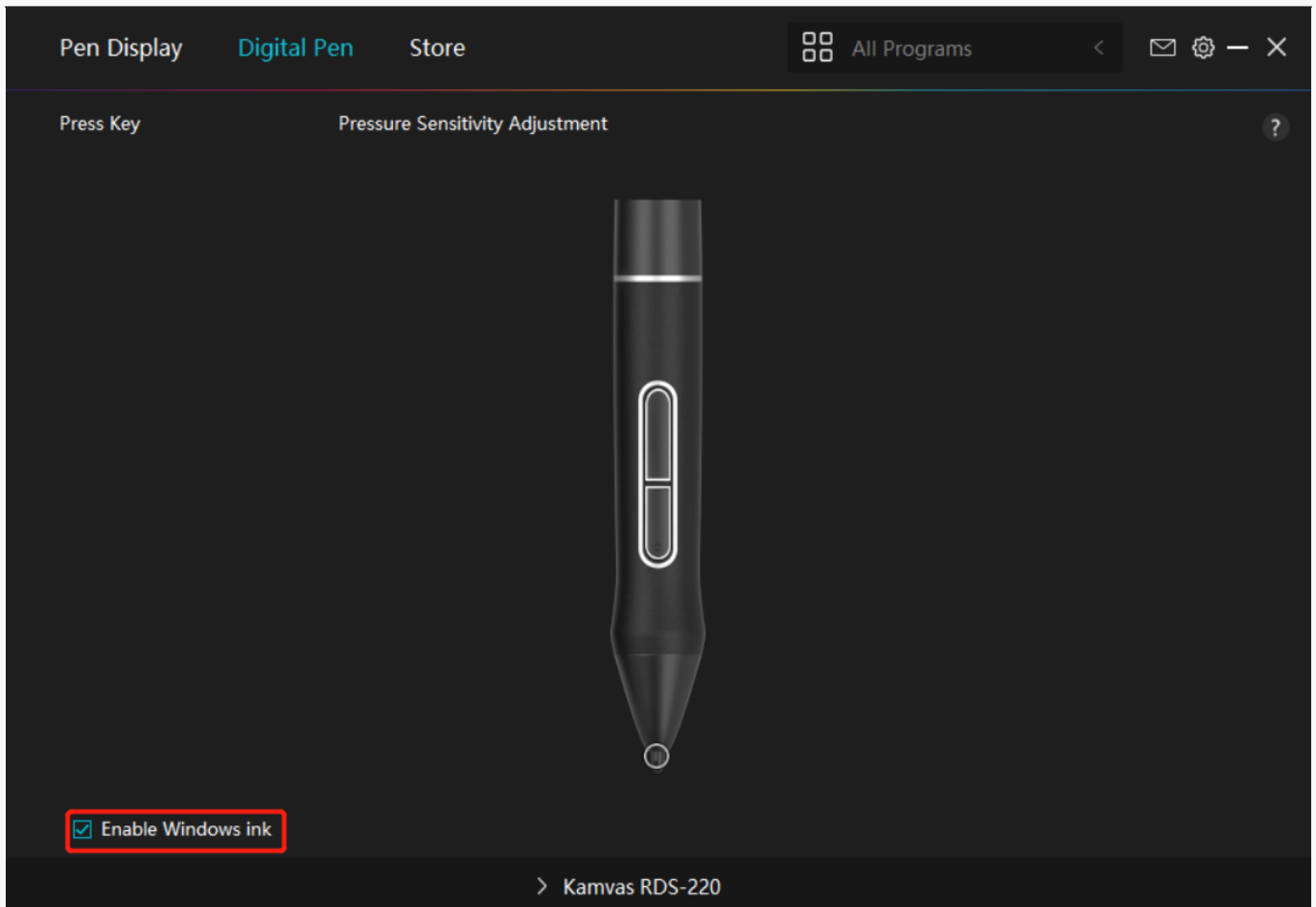

4. Pressure Sensitivity Adjustment

Users can adjust the pressure sensitivity level by dragging the slider in the Pressure Sensitivity Adjustment box according to your usage habits. Click the redo button at the top right to revert to the default pressure.

(1) To decide the force required for a pen to produce a click or a pressure sensation.

(2) You can change the slope of the pressure response curve.

(3) To determine how much pressure needs to be applied to the pen nib to reach the highest pressure sensitivity level.

*Draw lines in the Pressure Test box with the pen, and the bar on the right will simultaneously show the pressure changes on the pen nib. Click the "Delete" button above to remove the lines, reset the pressure sensitivity level and test it until you find the appropriate pressure sensitivity level.

*A steep curve means a more sensitive response.



Driver Setting

1. Device

You can view the information of the firmware and the connected product here.

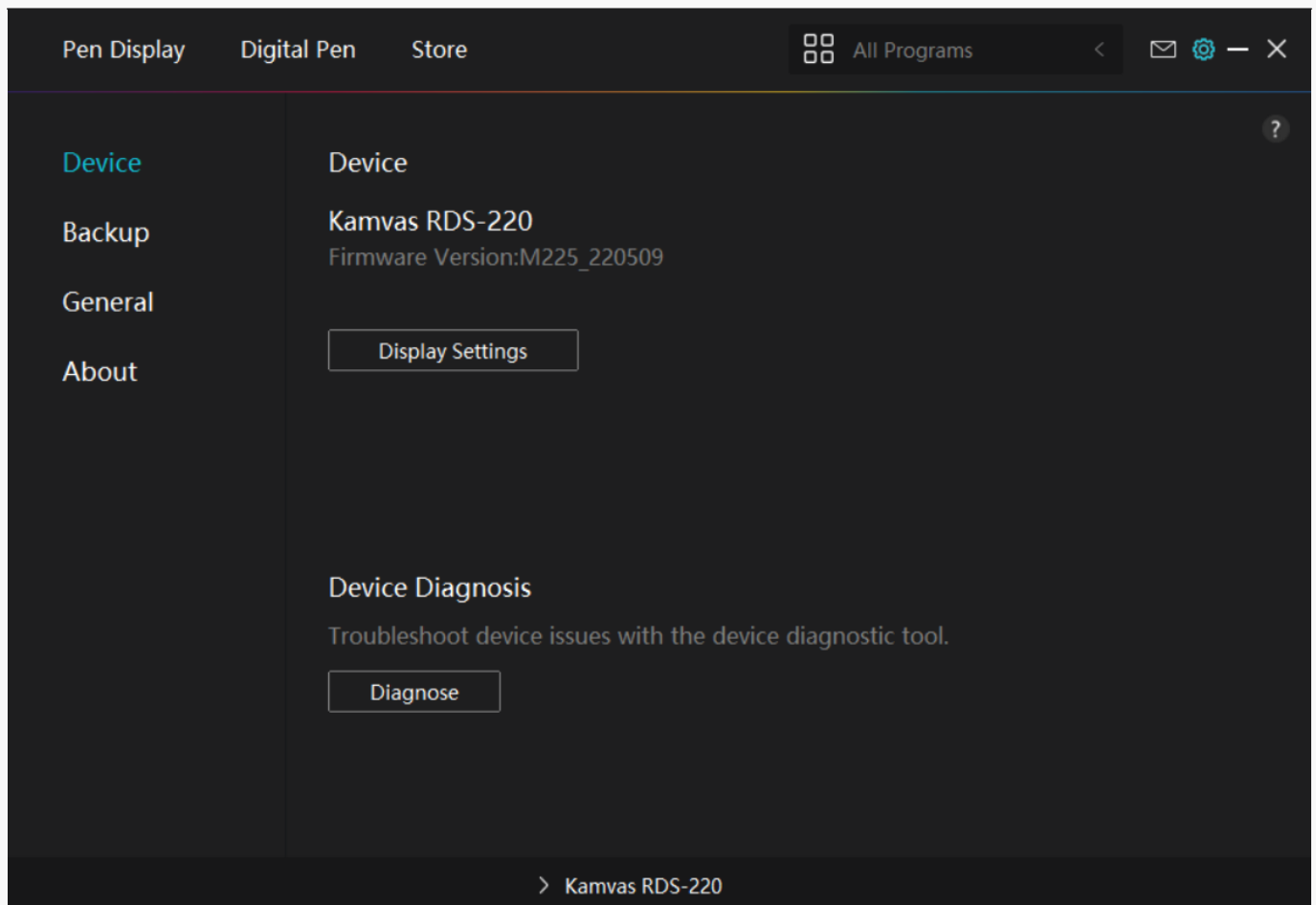

Display Settings

Scene Mode: "Standard Mode", "Gaming Mode", "Movie Mode", and "USER" to be chosen.

Brightness: Users can drag the corresponding slider to adjust the brightness.

Contrast Ratio: Users can drag the corresponding slider to adjust the contrast ratio.

Saturation: Users can drag the corresponding slider to adjust the saturation.

Color Setting: "Color Temperature" and "Color Space".

Color Temperature: "6500K", "9300K", "Custom Color" mode to be chosen. In "Custom Color" mode, users can change the color temperature by adjusting the RGB value.

Color Space: "Native", "sRGB", "AdobeRGB" mode to be chosen.

Note: For macOS users, the Display Setting is accessible only when a full-featured USB-C cable is used for the connection. If you need to change the display setting, please use a full-featured USB-C cable to connect your device.

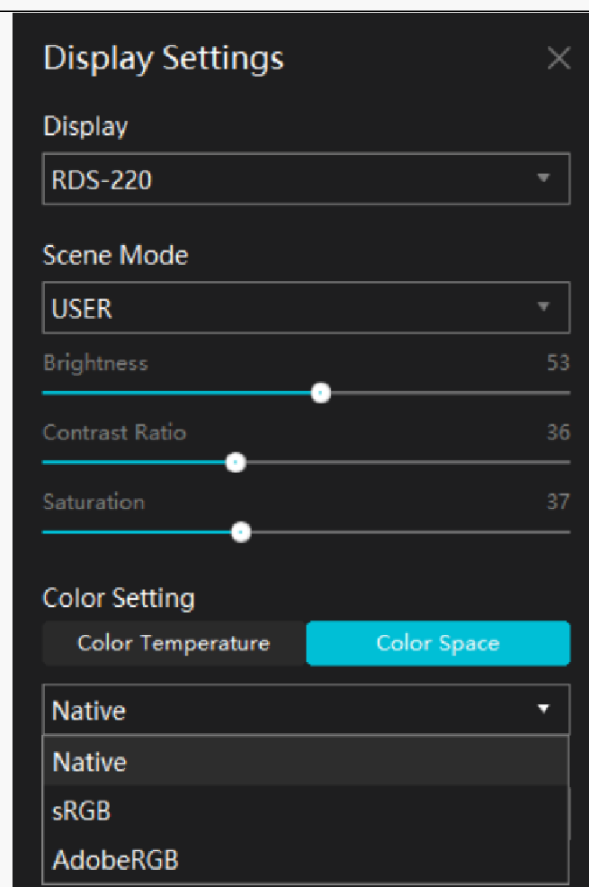
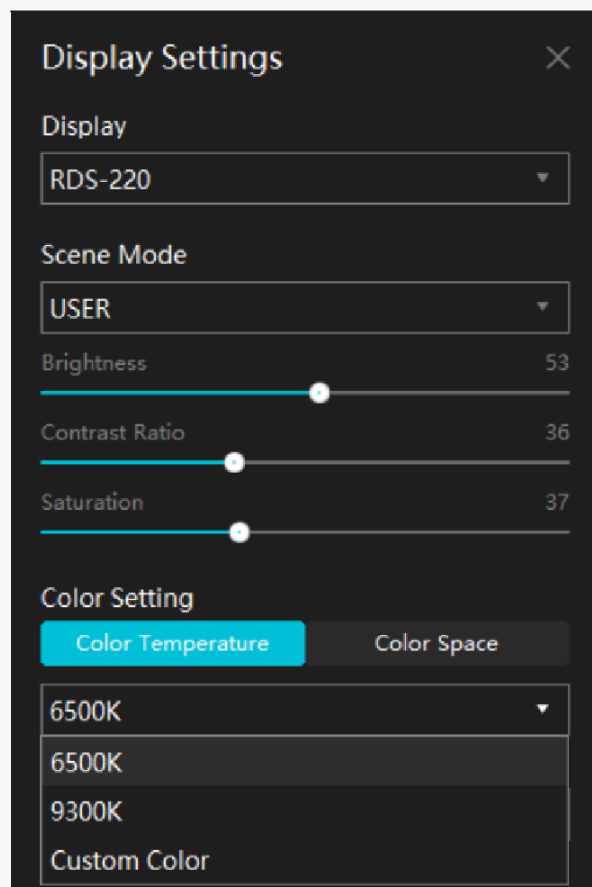

2. Backup

The Driver can import and export your custom settings, which helps to avoid repeated settings when launching a different program.

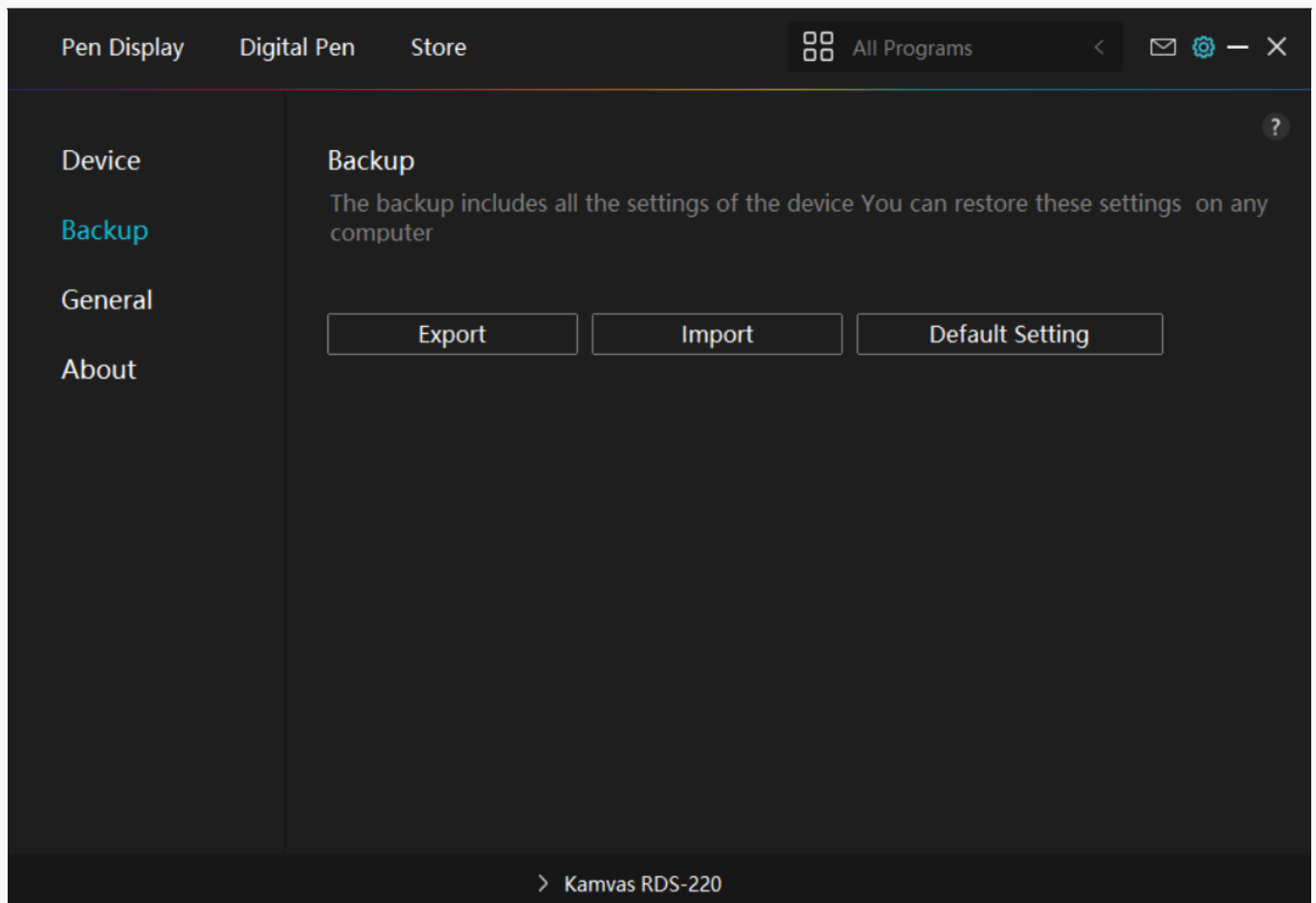

3. General Setting

Language: Click the drop-down button to select a language.

Color: You can select the color of the Driver interface among Dark, Blue, and Light according to your preference.

Start Menu: Click to enable or disable “Auto-Start”, “New Message Alert”, “Automatic Updates”, and “Share diagnostic and usage data”.

Hotkey: You can set a hotkey to call up the Driver interface quickly according to your usage habits.

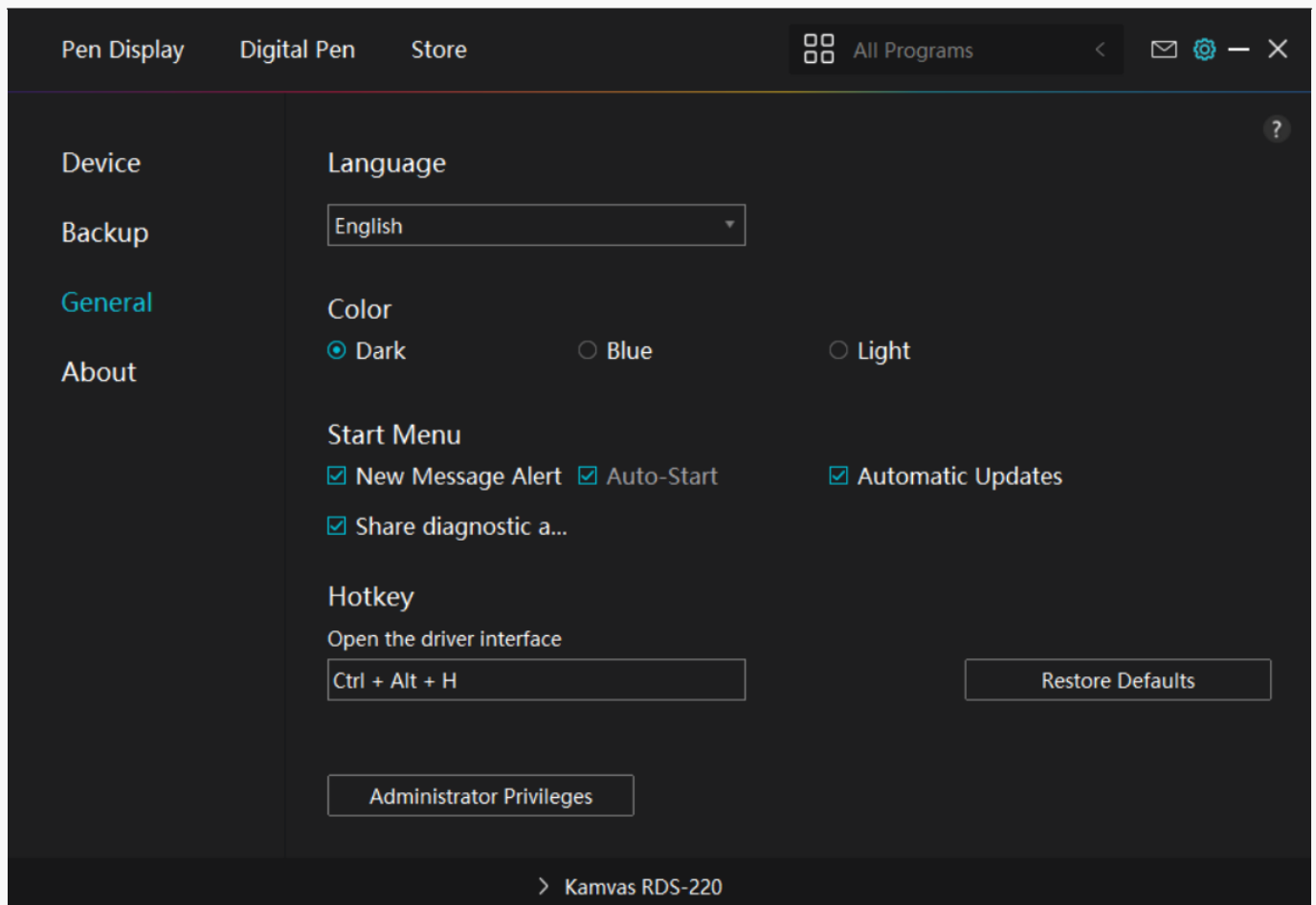

4. About

Users can check the Driver version number here. Click Check for Updates to view the latest Driver version and then follow the prompts to update the Driver if needed.

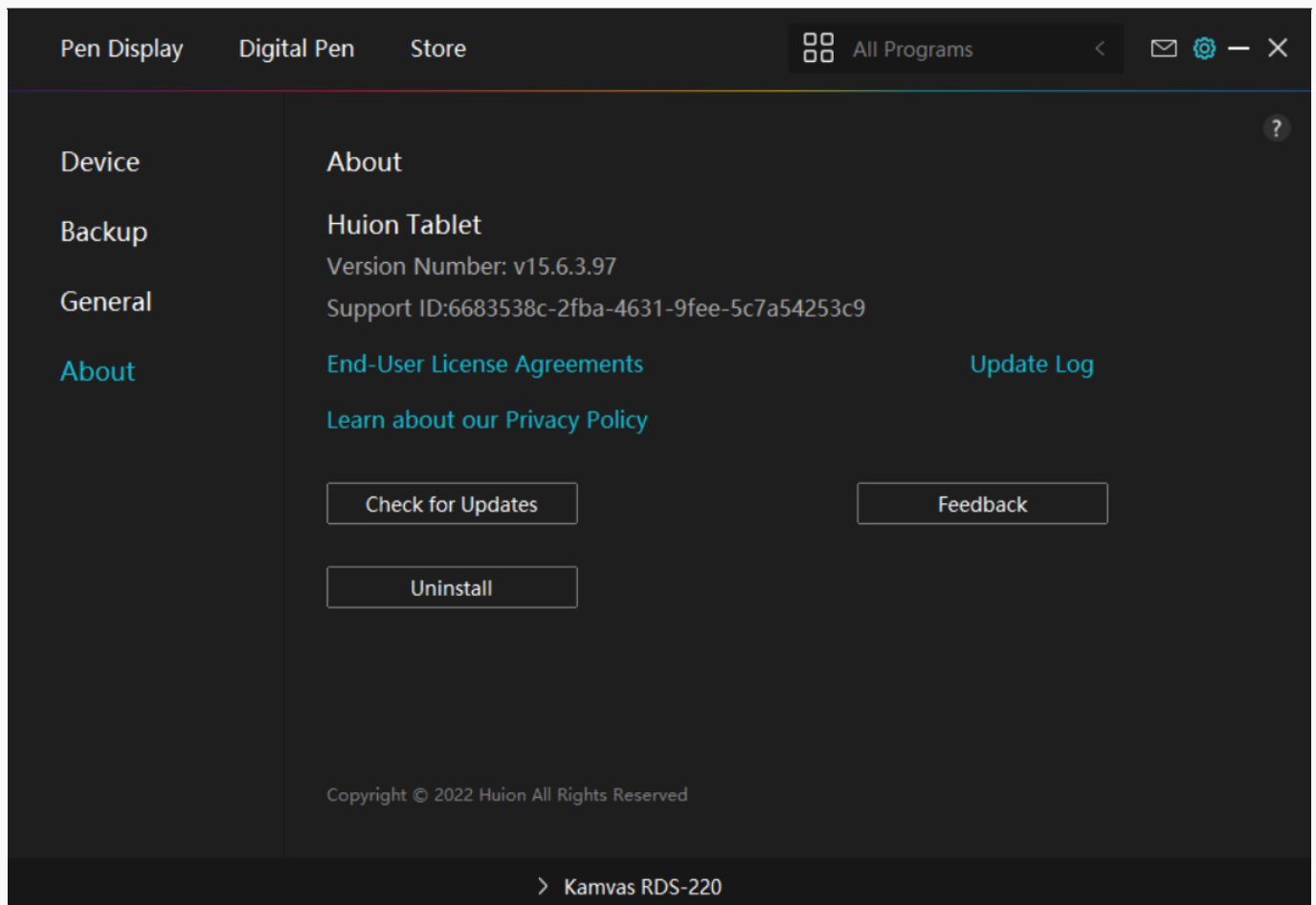

How to Use the Digital Pen

Hold the Pen:

Hold the digital pen as you hold a real pen. Adjust your grip so that you can toggle the pen press keys easily with your thumb or index finger. Be careful not to accidentally press the key while drawing with the pen.

Note: Please place the pen on the table when it is not in use. Do not put the pen on the pen display, otherwise it may interfere with the function of the mouse and other devices, and it may also prevent your computer from entering sleep mode.

Cursor Movement:

Move the pen slightly above the working area of the display without touching the surface of the pen display, and the cursor on the screen will move to the new position accordingly. Use the digital pen to touch the screen with a certain amount of force, and then you can make a left-click.

Click:

Tap on the pen display with the pen to register a click. Press lightly to highlight or select an item on the screen and double-click to open it.

Move:

Pick up a file or icon, then slide the pen nib across the display to move it.

Use the Pen Press Keys:

There are two press keys on the digital pen, whose functions can be programmed on the driver interface. The press keys on the pen will work as long as the vertical distance between the pen nib and the display is within 10mm.

Replace the Pen Nib:

Tip: When the pen nib is badly worn, please replace it with a new pen nib timely.

1. Rotate the pen holder counterclockwise and take out a replacement nib.
2. Tilt the pen, and pull the nib out of the pen through a nib clip.
3. Insert the replacement nib straight into the barrel of the pen until the nib stops moving forward.

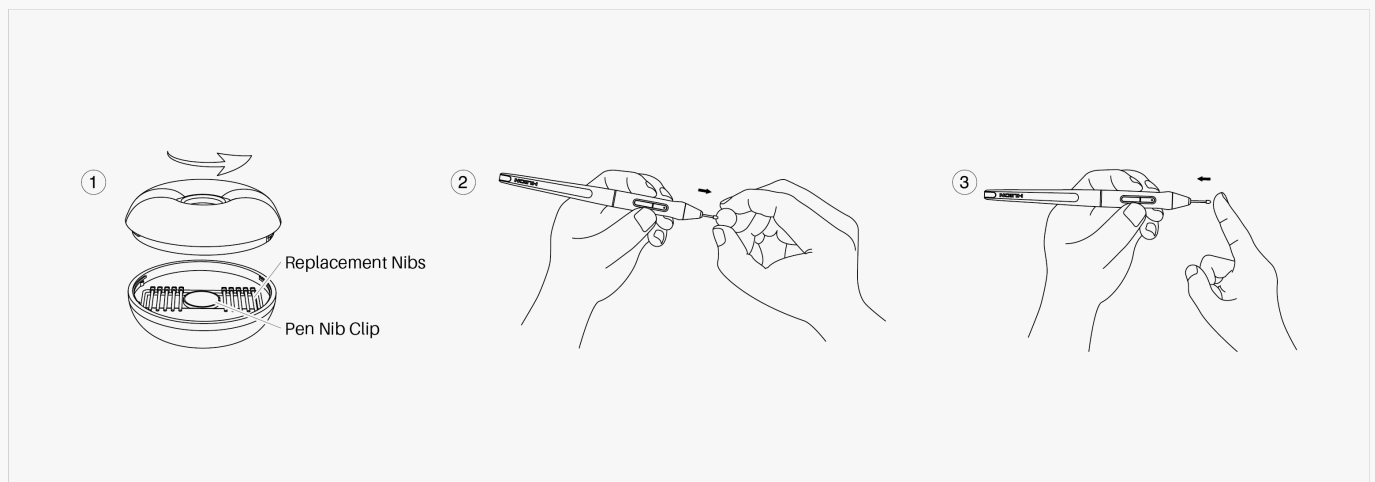

Troubleshooting Solutions

The pen display cannot sense the pen pressure while the cursor can move

You may have installed other drivers or run the drawing software when installing the driver. Please uninstall all the drivers, close the drawing software, and then reinstall the Huion driver.

It's suggested to restart your computer after finishing the installation.

The digital pen does not work

1. Make sure you are using the pen that originally came with your display.
2. Make sure you installed the driver correctly.

The press key does not work

1. Please check that the press key function is enabled in the driver;
2. Make sure you have correctly defined the press key.

The computer cannot enter sleep mode

Please do not place the digital pen on the working area of the pen display when you are not using it, otherwise the computer will not be able to enter sleep mode.

The press key of the digital pen does not work

The press keys of the digital pen will not work when the vertical distance between the pen nib and the display is over 10mm. If the vertical distance is within 10mm and the pen press key does not work, please check whether the driver works well and whether you have assigned functions to the two keys correctly or not. Then if the keys still do not work, maybe your pen is broken and you can contact our service team as long as the pen is under warranty.

The computer cannot recognize the pen display

Please check whether the USB port functions well. If not, please try another USB port.

Failed to connect Kamvas RDS-220 to other device and "Device Disconnected" appears.

Please restart your computer or driver; make sure the USB port and USB-C cable work well; unplug the USB cable and plug it again; try another USB port; download and reinstall the latest driver; please whitelist the driver on macOS devices.

If your problem is not resolved, please click [FAQs](#) to view more troubleshooting methods or email us(service@huion.com).